

CALIFORNIA STATE UNIVERSITY

Dominguez Hills

Extended Education



Summer 1994

First Session: June 6 - July 15 Second Session: June 27 - August 5

Our Mission:

**TO EXTEND THE RESOURCES OF THE UNIVERSITY
INTO THE COMMUNITY BY OFFERING PROGRAMS
OF NEED AND INTEREST TO ADULTS AND
NON-TRADITIONAL STUDENTS.**

Because the Division of Extended Education is self-supporting, It has flexibility in programming, and offerings may be non-traditional in subject matter, format, instructional mode, and time. This allows the Division to accomplish its educational mission in the broadest sense and also provide opportunities for experimentation in curriculum, faculty development and instructional design.

IMPORTANT DATES: SESSION I SESSION II

Registration begins	April 4	April 4
Mail-in Registration deadline	May 20	May 20
Regular Registration deadline	June 1	June 21
Last day to return books	June 13	July 5
Late Registration (\$25 fee assessed)	June 7 - 17	June 28 - July 8
Last day to ADD a course	June 17	July 8
Last day to request CREDIT/NO CREDIT option	June 17	July 8
Last day to DROP/WITHDRAW without "W"		
on record	June 17	July 9
Holiday, campus closed	July 4	July 4
Last Day to Drop/Withdraw	July 8	July 29

**NOTE: INTENSIVE COURSE DATES VARY
-PLEASE INQUIRE ABOUT SPECIFIC COURSES.**

Summer Sessions Office: Small College Complex, B-141. 1000 East Victoria Street, Carson, CA 90747 (310) 516-3741. Office hours: **Monday-Thursday 8am-6pm; 8am-5pm Friday** (During the 1st week of each session, office will remain open until 7pm, Monday - Thursday)

***Note:** The Summer Sessions Bulletin is printed by The Division of Extended Education at no expense to the taxpayer. Every effort is made to insure the accuracy of this Bulletin. However, this Bulletin is subject to change without notice. Please call (310) 516-3746 for further questions.*

Table of Contents

Summer Sessions Dates	pg 1
Registration & Tuition	
Who May Register	pg 1
How to register	pg 1
Late Registration	pg 1
Tuition & Fees	pg 1
Add/Drop/Withdrawal	
Adding a course	pg 2
Dropping a course	pg 2
Withdrawal	pg 2
Refund Policy	
Refund of Tuition Fee	pg 3
Refund of Parking Fee	pg 3
Cancelled Course Fee	pg 3
Academic Information	
Summer Sessions Office	pg 4
Maximum Student union load	pg 4
General Studies	pg 4
Advisement for	
Summer Courses	pg 4
School of Management	
Advisement Center	pg 4
Course Numbering System	pg 4
High School Students	pg 4
Grade Reports/Transcripts	pg 5
Audit	pg 5
Credit/No Credit Grading	pg 5
Independent Study	pg 5
Final Examinations	pg 5
Entry Level Mathematics	
Requirement	pg 5
Student Services	
University Bookstore	pg 6
Disabled Student Services	pg 6
University Library	pg 6
Information Center	pg 6
Testing Office	pg 6
Cafeteria and Food Service	pg 6
Health Programs and	
Psychological Testing	pg 6
Parking	pg 7
Activities Office/Student Union	pg 7
Student Housing	pg 7
Evening Information Services	pg 7
Schedule of Courses	pg 9 - 24
Map.....	pg 27

**Registration
Form Inside
BackCover**

SUMMER 1994

Registration and Tuition

Who May Register

College students, graduates of high school, or individuals sufficiently knowledgeable to profit from college courses may register for Summer Sessions. High school juniors and seniors, with letters of recommendation, may enroll in lower-division courses (see details on page 4). If you are a visiting student, it is especially important that you read the section on classification and numbering of courses. Descriptions of the courses are available in the University Catalog found in the University Bookstore. Registration in CSUDH Summer Sessions courses does not constitute admission to the University as a regular student. If you are interested in admission to the University, inquire or apply at the University Information and Service Center, Small College Complex A-130, (310) 516-3696.

How to Register

Registration in CSUDH Summer Sessions is simple, and in most cases can be completed entirely through a mail-in procedure. Formal application to the University is not necessary, and transcripts are not required. Some Summer Sessions courses, however, have prerequisites or special qualifications which are noted in the Schedule of Courses. In certain cases, before the request to register can be processed, permission to enroll in a course must be obtained from the instructor or department office, or students may be asked to provide proof of completion of prerequisites. To attend Summer Sessions classes, registration for courses must be completed, including full payment of fees, by the appropriate deadline dates (refer to Calendar on page i). If you are registering for both Summer Sessions and University Extension courses, please use separate registration forms and write separate checks.

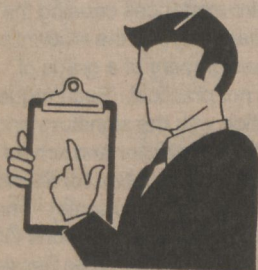

To Register By Mail:

Complete the Summer Sessions Registration Form on the inside back cover of this Bulletin and mail it to:

**CSU Dominguez Hills
Summer Sessions
Office
1000 East Victoria
Carson, CA 90747**



Include your check, money order or credit card information; do not send cash. The deadline for Mail-in Registration is May 20, 1994, two weeks before the First Session begins (consult calendar on page i).

To Register By Fax:

FAX your complete Summer Sessions Registration Form (inside back cover) and your credit card information to (310) 516-3971.



To Register in Person:

You can register in person at the Summer Sessions Office located on the CSU Dominguez Hills campus, SCC B141. The Summer Sessions Office accepts check, money order, cash (exact change), VISA and MasterCard.



Late Registration

(For adding courses to a program, see ADD Instructions.) The late registration period begins June 7, and concludes June 17 for the First Session. Late registration begins June 28 and concludes July 8 for the Second Session. Completion of late registration is dependent upon availability of seats for each class and is subject to a \$25.00 late registration processing fee.

Non Standard Date or Intensive Courses
In order to register for a course which begins after the first week of either Session, the student must complete the late registration procedure by the second day of this class.

Tuition and Fees

Fees and refunds are subject to change by the Trustees of the California State University. Full payment of all tuition and fees must be made at the time of registration or adding a course. Payment of tuition and fees may be made by check, money order, cash, (except mail-in registration) and VISA or MasterCard. Checks and money orders are payable to CALIFORNIA STATE UNIVERSITY, DOMINGUEZ HILLS. Until total fees are paid, registration is not valid.

Tuition

Total course fee is listed in the Schedule with the course information. Some courses, such as laboratory or activity courses, have higher costs and may have fees that are higher than the standard instructional fee.

Standard instructional /lecture fee per unit \$115
Special course fee as listed

Fees

Student activity (pay once per summer)	\$3.00
Student Union (pay once per summer)	\$10.00
Late registration	\$25.00
Returned check	\$10.00
Transcript	\$4.00 each
Lab fees	\$25.00-50.00

Parking

All vehicles, including motorcycles, parked on this campus, must have a valid parking decal. Single entry parking permits can be obtained for \$1.50 from a yellow vending machine near the entrance of each general parking lot. Restricted parking areas are enforced at all times. Parking decal's are available at the Cashier's Office (SCC B135).

Six-week auto decal	\$21.60
Nine-week	\$32.40
Ten-week	\$36.00
Short term, per week	\$3.60
Two-wheeled vehicle	\$9.00
Single entry machines	\$1.50

Returned Checks

All returned checks, whether for insufficient funds or stop payments, are considered to be enforceable debts, and are subject to a \$10.00 fee. If your check is returned, your registration will not be processed.

SUMMER 1994

Add / Drop / Withdrawal

Adding Courses

To add a course before the start of the Session, submit your completed Add / Drop Form and the additional tuition to the registrar in the Summer Sessions Office.

To add a course after the start of the Session, you must file a Change of Program form available in the Summer Sessions Office and have it signed by the professor for the class you want to add.

Courses may be added during the first two weeks of the session. The deadline for adding courses is June 17 for the First Session and July 8 for the Second Session.

Students may exchange one class for another within the same Session without penalty, if the unit and tuition value is the same.

If you will exceed a maximum unit load by adding courses, you must also submit a Petition to Exceed Maximum Units, available in the Summer Sessions Office (refer to policy on Maximum Unit Load).

NTE (NATIONAL TEACHER EXAM CORE BATTERY)

TEST PREPARATION AND REVIEW

This session is designed to assist prospective teachers in preparing for the Core Battery of the NTE (Literature and Fine Arts, Mathematics, Science and Social Studies) by teaching techniques and strategies that will help student apply their skills and knowledge. A review of basic mathematics will be included. A one hour lunch break is given for each full-day class.

STUDENTS MAY REPEAT THE CLASS AT NO CHARGE.

NTE Review for June 11 Exam

- 3 mtgs: Sat & Sun, May 21,22, & June 5 9:00 - 4:00 PM
- CSUDH Campus,
- \$185

For more information or to register for this course, please call the CSUDH Division of Extended Education at (310) 516-3741

Dropping / Withdrawing

Non-attendance in class, notifying the instructor, or stopping payment on a check does NOT officially constitute dropping or withdrawing from a course. The Summer Sessions Office must be notified and appropriate forms must be completed.

Dropping a Course

If you decide to drop a course, you must file a Change of Program Form with the Summer Sessions Office. (If you are dropping all courses you enrolled in, follow withdrawal procedures.) Refer also to Refund policies.

Drop, prior to first day of Session. To drop a course before a Session begins, file a change of Program form and an Application for Refund of Fees in the Summer Session Office.

Drop, during the first two weeks of the Session. Summer Sessions students may drop or withdraw from any course prior to and during the first two weeks of a Session without permanent record of enrollment or "W" on transcript, and without the instructor's signature.

Drop, third through fifth weeks of the Session. During the third and until the final week of the Session, the instructor's and the school dean's or associate dean's signatures for each course are required on the Change of Program form in order to drop. Non-matriculated or Summer-only students need the signatures of the instructor and the Dean of Extended Education.

If a student drops or withdraws after the second week of a Session, a grade of "W" for the course(s) will appear on the student's permanent transcript.



Complete Withdrawal from Session

To withdraw from all courses, complete and submit a Withdrawal form, and, if you are eligible for a refund, an application for a refund of fees. Withdrawal forms are available in the Summer Sessions Office.

Complete withdrawal, prior to first day of Session. If you find it necessary to drop all courses before a Session begins, you must cancel your registration and you may be eligible to receive a full refund of fees, less a non-refundable processing fee. A completed Withdrawal Form and a refund Application must be received by the Summer Sessions Office by June 3 for First Session or by June 24 for Second Session.

Complete Withdrawal, during the first two weeks of the Session. You may withdraw during the first two weeks without a record of enrollment and without the instructor's signature. Complete a Withdrawal Form and a Refund Application and submit these forms to the Summer Sessions Office by the end of the second week.

Complete withdrawal, third through fifth week of the Session. A grade of "W" for each course appears on the permanent transcript if the student withdraws after the second week of the Session and is doing passing work. To withdraw from all courses after the second week of instruction, complete a Withdrawal form, obtain the signatures of the instructor and school dean (or Dean of Extended Education, if you are not a regular student) on the Withdrawal form. Submit these completed forms to the Summer Sessions Office.

Withdrawal from classes during final exam week (last week of Session) is not permitted, except in such cases as accident or serious illness where circumstances causing the withdrawal are clearly beyond the student's control, and the assignment of a grade of Incomplete is not practical. Such requests require a Petition with the signature and approval of the instructor and school dean (Dean of Extended Education for Summer-only or non-matriculated students). The form is available in the Summer Sessions Office and must be filed in the Summer Sessions Office with documentation by the last day of the Session in which the student was enrolled.

SUMMER 1994

Refund Policy

Refund of Tuition Fee

Refunds are not automatic. Even if the University cancels a scheduled course, you must make an application to have your tuition fees refunded. Refunds are subject to change without notice by the Trustees of California State University System. Amounts of refund are calculated according to the Formula for Refunds established in Title 5 of the California Administrative Code.

Refund Applications are available from the Summer Sessions Office. This form must be filed in person with the Summer Sessions Office. Your Schedule Confirmation and the tear off receipt from the Change of Program form (if applicable) must accompany the written request. No transaction will be made without a receipt. Students must submit refund requests by the published deadlines (refer to Calendar and Refund Schedule). The effective date of the refund request, for purposes of calculating amount refunded, is the day it is received by the Summer Sessions Office.

Allow approximately six weeks from the date the request is received for processing refunds.

Refund of Parking Fees

Written application for a refund of parking fees must be accompanied by a permit or decal which the University has issued. Applications for refund is determined by the following policy: 50% of all remaining full weeks; however no refund for remaining periods of less than two weeks.

Refund Schedule

The formula used for calculating the amount of fees refunded for five weeks or longer sessions is as follows. If you apply for a refund prior to the first day of the Session, June 3 or June 24, you may receive total tuition minus \$10.00. If you apply for a refund on the first or second day of the Session, you may receive total tuition minus the fee for one unit. During the remainder of the first week of the Session, if you apply, you may receive total tuition minus one unit times 65 percent. During the second week of the Session, if you apply, you may receive total tuition minus one unit times 25 percent. After the second week, none of the fee may be refunded. The late registration fee is non-refundable.

Please note that tuition refunds are based upon the start date of the Session and not upon the first day a particular course meets.

Cancelled Course Policy

If you are enrolled in a course that is cancelled for any reason, you must complete an Application for Refund or arrange for another course by completing a Change of Program form. The University does not refund fees automatically in the event of a course cancellation.

Learn, Live & Love Spanish in Cuernavaca Mexico

3 or 4-week sessions
July 8 - 29, 1994
or
July 8 - August 5, 1994

A complete Spanish language immersion program designed to develop conversational fluency in the shortest possible time.

Travel Study Program offers:

An intensive Spanish language immersion program with daily classes.

The picturesque village of Cuernavaca in central Mexico.

Live with a Mexican family willing to welcome you into their home and share with you the warmth of Mexican home life and their willingness to provide additional conversation practice to students.

Optional half-day and full-day local excursions.

Optional professional terminology sessions.

Advancement toward your degree or career goal: earn 3 semester units of CSU credit in Spanish.

No prior knowledge of Spanish required.

For more information

To receive more information or a detailed brochure, return the coupon below or call the Division of Extended Education at (310) 516-3741.

SCHEDULE FOR REFUND OF TUITION FEES

FIVE-WEEK OF LONGER SESSIONS

No. of Units	Amt. paid	Prior to first day of Session	First two days of Session	Any other day of first week	Any day of 2nd week
1	\$115.00	\$105.00	\$00.00	\$00.00	\$00.00
2	230.00	220.00	115.00	74.75	28.75
3	345.00	335.00	230.00	149.50	57.50
4	460.00	450.00	345.00	224.25	86.25

THREE OF FOUR WEEK SESSIONS

No. of Units	Amt. paid	Prior to first day of Session	First two days of Session	Any other day of first week	Any day of 2nd week
1	\$115.00	\$105.00	\$00.00	\$00.00	\$00.00
2	230.00	220.00	115.00	74.75	28.75
3	345.00	335.00	230.00	149.50	57.50

2 WEEKS OR LESS: NO REFUNDS WILL BE MADE

Session #1: June 6 - July 15
Session #2: June 27 - Aug. 5

Please send me more information about the Cuernavaca Travel Study Program:

Name: _____

Address: _____

City: _____

State, Zip: _____

Mail to : CSUDH, Extended Education
1000 E. Victoria, Carson, CA 90747

SUMMER 1994

Academic information

Summer Sessions Office

Small College Complex SCC B-141, 310/516-3746

Processing of general registration, late registration, adds, drops withdrawals, and other academic transactions related to Summer Sessions enrollment will take place in the Summer Sessions Office.

The office hours are 8:00 a.m. - 6:30 p.m., Monday through Thursday during the first week of both sessions and 8:00 a.m. - 6:00 p.m. and 8:00 a.m. to 4:00 p.m. on Fridays, throughout the remainder of the summer. The office is closed on weekends and on July 4.

Maximum Student Unit Load

The total units a summer student may earn:

Session 1..... 7 units

Session 2..... 7 units

Sessions 1 and 2..... 10 units

Exceptions to the above are based on proven academic ability and the feasibility of the student's schedule. Students wishing to exceed these unit limits must obtain and complete a special petition available in the Summer Sessions Office and request permission from the dean of the school governing their major. Visiting students or non-matriculated students must request permission from the Director of Summer Sessions.

General Studies

The general Studies program is the nucleus of the undergraduate curriculum at CSUDH, deliberately structured to provide the intellectual and effective foundation required of a well-educated person. The philosophy underlying General-Studies offerings is that they are courses for non-specialists, presenting subject matter related to wider context of knowledge and stimulating interest in lifelong learning. General Studies courses present breadth, deal with representative concepts, and provide some integration of concepts.

Several of the courses which comprise this curriculum are offered in Summer Sessions. These General Studies courses are designated by the "GS" symbol next to the Schedule number. For an overview of the General Studies program consult the University Catalog, pages 80 - 87 available in the University Bookstore.

University Advisement Center

Small College Complex SCC M-110 310/516-3538

Regularly enrolled students may obtain academic advisement for their summer schedules during Spring Semester when faculty and advisors are available. The Summer Sessions Office does not provide academic advisement. Many questions are answered in the university Catalog which includes course descriptions and course prerequisites in addition to policies and programs of the University. The Catalog is sold at the University Bookstore.

In addition, the University Advisement Center is available for information advisement at (310) 516-3538. Office hours are Monday - Thursday 8:30a.m. - 6 p.m. and Fridays 8:30a.m. - 5:00p.m. and by appointment.

School of Management Advisement Center

Social & Behavioral Sciences Building A-306, 310/516-3561

Summer Sessions students who wish to enroll in any undergraduate business courses must obtain approval to enroll from the Business Advisement Center. Visiting or non-matriculated students are asked to bring transcripts, grade reports, and/or college records to the Center before seeking approval. Call 310/516-3561 for days and hours of advisement.

Any student wishing to enroll in a School of Management 500-level course must receive approval and signature from the MBA Program Office located in SAC 2149



Course Numbering System

The course numbering system for the University is based upon three-digit numbers as follows:

- 000-099 Sub-collegiate courses, not for baccalaureate credit.
- 100-199 Lower division courses, normally taken in the freshman year.
- 200-299 Lower division courses, normally taken in the sophomore year.
- 300-399 Upper division courses, normally taken in the junior year.
- 400-499 Upper division courses, normally taken in the senior year.
- 500-599 Graduate courses, normally limited to graduate students.

High School Students

Qualified high school students who will enter the junior or senior year in Fall 1994 can register for Summer Sessions lower division (100 level) courses with a letter of recommendation from the school principal or counselor and written authorization from the parents. Address letters to the Dean of Extended Education, California State University, Dominguez Hills. Students pay regular summer fees, and the course credit they earn may be applicable to a degree from CSUDH or another institution.

**CSUDH**



ALUMNI ASSOCIATION

With more than 28,500 graduates, our alumni family has grown so large that many of you may be lost.

Dominguez Hills Alumni,
if you haven't heard from
us in a while.....

PLEASE PHONE HOME!!

**Alumni
Relations**

310/516-4237

Mail-in Registration Deadline: May 20, 1994

SUMMER 1994

Academic Information

Grade Reports and Transcripts

Student performance in each course is reported at the end of the Session by one of the following grades (with grade points earned):

GRADE	GRADE POINTS
A	4.0
A-	3.7
B+	3.3
B	3.0
B-	2.7
C+	2.3
C	2.0
C-	1.7
D+	1.3
D	1.0
F	

The following grades are to be used for approved courses only:

CR Credit (not counted in grade average, but units allowed). Undergraduate level only.
SP Satisfactory Progress (credit is deferred until completion of course sequence).
NC No Credit (not counted in GPA, no units allowed).

A report of final grades assigned in classes will be mailed to you about three weeks after the end of the session.

A student may obtain an official transcript of enrollment and grades upon completing a Request for Transcript available at the office of Records and Registration. This request should be filed no earlier than the last week of the session in which the student is enrolled. Allow at least three weeks after the end of the session for delivery of the transcript copy. A fee of \$4.00, payable at the Cashier's Office, is charged for the first transcript request. Transcripts are not issued to a student whose record indicates financial obligation to the University.

Grades for nonstandard-date courses will be posted with standard course grades at end of Session.

Audit

Summer students may audit a course on a space available basis with the permission of the instructor. Auditors pay regular course fees. To enroll as an auditor, the student must submit a Change of Program form with the instructor's signature to the Summer Sessions Office.

Students must officially change their status in a course from credit to audit by the end of the first week of instruction.

Credit / No Credit Grading

In accordance with the current Credit / No Credit policies, the undergraduate Credit (CR) grade is the equivalent of an A, B or C letter grade, and the No Credit (NC) grade is the equivalent of a C-, D or F. CR / NC grades are recorded on student transcripts. An undergraduate may elect to be graded CR/NC in particular courses, subject to conditions which are described in the University Catalog. To receive a Credit / No Credit grade in a Summer Sessions course (except when the course is graded solely on Credit / No Credit basis), the student must complete the Credit / No Credit form, available in the Summer Sessions Office by the end of the second week of instruction.

Independent Study

Independent or directed study courses are intended for the regularly enrolled, matriculated students in order to enhance or supplement their curriculum. To enroll for independent or directed study, the student must obtain a contract from the Summer Sessions Office. This contract must be completed, including the signature of Dean, and submitted with student's registration. A student will not be registered for independent or directed study unless a completed contract has been submitted. Only course numbers listed with departments may be used; be sure the correct Session and number of units are on the contract. The same registration deadlines and policies apply to independent study.

Final Examinations

Final examinations are administered during the final week the course is scheduled to meet. Usually the examination is given on the last day the the course meets. No adds or drops are accepted during or after the last week the class meets.

Entry Level Mathematics (ELM) Requirement

CSU students wishing to enroll in any Summer Sessions mathematics classes will have to provide evidence of having satisfied the ELM requirements. This requirement can be satisfied by any of the following methods.

1. Having an ELM score which meets the minimum for placement in a particular class.
2. Satisfactory test score on ACT / SAT test.
3. A transcript showing passing grades on a college level mathematics course above the level of Intermediate Algebra.

Contact math department for prerequisite clearance

Visitors from other Universities / Colleges should bring evidence that they have met the prerequisites for the course they wish to take.



SUMMER 1994

Student Services

Loker Student Union 310/516-3789

Textbooks, course materials, the University Catalog, supplies, giftware, and clothing are available at the Bookstore. Summer hours are:

Monday - Friday, 8:30 a.m. - 4:00 p.m.

During the first week of each Session, the Bookstore remains open until 7:00 p.m., Monday - Thursday; until 4:00 p.m. Friday.

The Bookstore is closed on weekends. Bookstore hours are subject to change.

The last day to return textbooks for the First Session is Monday, June 13.

The last day to return textbooks for Second Session is Tuesday, July 5.

Disabled Student Services Student Health Center A106, 310/516-3660 TDD/516-4028

Disabled Student Services is committed to the student with a disability and to his or her right to an equal educational experience. Students having a disability which is either permanent or temporary in nature are eligible for a variety of support services including:

Admissions / Registration Assistance
Priority Registration
Readers - Note - takers - Interpreters
Assistive devices and equipment loans

University Library

Educational Resources Center 310/516-3714

During Summer Sessions, June 1 to July 30, the library is open as follows:

Monday & Tuesday: 8:00am-7:00pm
Tuesday & Wednesday: 8:00am-9:00pm
Friday: 8:00am-5:00pm
Saturday: 11:00am-3:00pm
Sunday: Closed
July 4: Closed

Information Center Small College Complex A-130, 310/516-3696

The center assists the Campus population, prospective University applicants, and community members by providing essential centralized information on campus resources, activities, and programs. The Center also makes appropriate referrals to other campus units. Brochures, maps, directories, and other materials are available to students and visitors.

The Center functions include handling all application requests, providing information on admission policies and procedures, giving preadmission advising. Summer hours are:

Monday-Friday 8:00a.m. - 5 p.m.

Testing Office Small College Complex N-124, 310/516-3909

The Testing Office provides information and registration materials for the GRE, SAT, ACT, GMAT, MCAT, CLEP (credit by exam programs) and CBEST.

Food Service Loker Student Union 310/516-3814

Concessions and catering services will be available Monday through Friday throughout the summer. Check with the office in the Cafeteria for hours of operation.

Food vending machines are located in Social and Behavioral Sciences building (SBS) and outside of the first floor of the Educational Resources Center (ERC) building.

Health Programs and Psychological Counseling Student Health Center A141, 310/516-3818

The Health Programs and Psychological Counseling unit offers personal counseling during the Summer Sessions. Students must have attended Spring Semester 1994 in order to be eligible for counseling.

Summer Extension Specials

The Division of Extended Education is offering a variety of credit and non-credit courses this summer outside of the normal Summer Sessions framework. Courses are designed for professionals development or personal interest.

Some of the courses offered include:

- Intro to Quark Xpress
- Construction Management Certificate Program
- Professional Supervision Certificate
- Real Estate Appraisal Certificate
- Technical Writing Certificate
- Occupational Health & Safety Certificate
- And much more

For more information or a complete listing of the University Extension courses this summer, return the coupon or call (310) 516-3741.

Please send me an Extended Education Bulletin for Summer, 1994.

Name _____

Address _____

City/St/Zip _____

MAIL TO:

CSU Dominguez Hills, Extended Education,
1000 E. Victoria, Carson, CA 90747

SUMMER 1994

Student Services

310/516-3556

The Donald P. and Katherine B. Loker University Student Union opened to the Dominguez Hills community in the fall of 1992. Its purpose is to provide a dynamic educational, social, recreational, and cultural environment for residential and commuter students, faculty, administrators and the community. It is intended that the University Student Union's facilities, programs and services will play a central role in enriching University life and contribute to out-of-classroom learning experiences. It is a pedestrian crossroads of the campus community and its activities.

The University Student Union houses the office of the Director, Students Activities, the Associated Students Inc., Bookstore and Campus Dining. Services available include, Food Court and Cafeteria, Bistro, Bookstore, television rooms, recreation room (billiards, ping pong, video and board games), a variety of lounges and meeting rooms. Rooms for special events can be reserved and catering services provided; contact the union office for additional information.

Cashier

**Small College Complex
B-135, 310/516-3812**

The Cashier's Office will be open: 10:00am to 6:30pm M-Th & 10:00am to 5:30pm Friday.

Veteran's Services Student Health Center A106, 310/516-3643

Veterans are assisted in dealing with the Veteran's Administration, the State of California Department of Veteran's Affairs, and with problems that are a barrier to their success on campus.

Veterans are encourage to utilize the following services available for both day and evening students.

- * Pre-admission advisement
- * Veteran's benefits counseling
- * Tutorial assistance
- * Special admissions to the University
- * Vocational Rehabilitation Program
- * Academic advisement

Student Housing P.O. 6228, Carson, CA 90749 310/516-4228

On-campus Summer Sessions Housing is available to all students attending, but space is limited. Information regarding on-campus housing may be obtained by writing or phoning the Department of Student Housing (address and phone above).

Parking

**Small College Complex
A122, Department of Public
Safety, 310/516-3725/3639**

All vehicles which park on this campus must display a valid parking permit. (Sec. 21113a CVC). Summer Parking permits are purchased from the dispensing machines located at: Lot 1, Information Booth, Lot 3a, Lot 3 and Lot 4. (Should a dispensing machine malfunction, lease contact the Information Booth attendant or call the University Police at 516-3639, or use an emergency call box.) Vehicles are to park "head in" using marked stalls only.

Daily (\$1.50) parking permits must be displayed on the vehicle's dashboard. Summer Session permits are displayed inside the front windshield on the driver's side near the VN plate. This "static" type permit can be removed and transferred to another vehicle if the need arises. Permits must be displayed in plain view without obstruction. Car covers are not recommended.

Motorcycles, scooters, and mopeds have special areas for parking: SW corner of Lot 2, SE corner of Lot 3 and NW corner of Lot 4. Visitor parking areas are located in the front of the Small College Complex, outside of Lot 3a on the north perimeter road, and the gymnasium lot. These stalls are free, no permit required for 30 minutes.*

Loading zones are located adjacent to major campus buildings. No permit is required for 30 minute parking.*

Those who receive parking citations are reminded that pursuant of Sec. 40202 and 40500 CVC, these citations cannot be cancelled or rescinded by the University Police. Should there be significant error on the part of an officer or campus official, the issuing officer will request the court to rescind the citation. Failure to resolve a parking citation will result in difficulty with renewal of the vehicle's registration. For further information, please contact the Parking Office at 310/516-3725.

Open University

THE EASY WAY TO TAKE REGULAR UNIVERSITY
CLASSES WITHOUT FORMAL ADMISSION TO THE UNIVERSITY

As a participant in Open University, earn up to 24 units toward a baccalaureate and 6 units toward a master's degree.

Open University Fall '94 begins the first day of classes, August 27.

For more information about the program, return the coupon below or call the Division of Extended Education, (310) 516-3741.

Please send me an Open University Brochure:

Name _____
Address _____
City/St/Zip _____

MAIL TO:

CSU Dominguez Hills, Extended Education, 1000 E. Victoria,
Carson, CA 90747

** Should circumstances prevent the visitor from moving their vehicle after 30 minutes, contact the University Police at x3639 for extended parking.*

Session #1: June 6 - July 15
Session #2: June 27 - Aug. 5

TRAVEL OPPORTUNITIES



SUMMER/FALL 1994 - WINTER 1995 TRAVEL/STUDY PROGRAMS

Experience the joy of discovering ancient, modern, and unexpected places on special trips that are unlike conventional tours.

Unique features of these travel/study programs include:

- College faculty escorts and in-country specialists who share their insights about the contemporary, natural and historical aspects of the destinations visited.
- National and local guides chosen for their knowledge, efficiency, enthusiasm, and fluency in English.
- Comfortably paced itineraries that allow time to revisit a particular site that has sparked your interest. First class accommodations and local transport allow you to combine a comfortable vacation with learning.
- Contact with local people and their lifestyles through specially arranged small group luncheons in the relaxed and hospitable atmosphere of their own homes.

The sixteen travel/study programs listed below balance visits to "shouldn't miss" sites with experiences not available on conventional tours. For example:

- View a slide/lecture presentation by the Curator of the Pyramids of Giza at the foot of the great pyramids in Egypt.
- Learn about animal behavior and the interrelationship of "land, people, and animals" from a wildlife researcher at her camp at the foot of Mt. Kilimanjaro in East Africa.
- In Morocco, hear a lecture by King Hassan's personal interpreter and have lunch in the homes of Moroccan families in the ancient Medina of Fez.



**October 15 - 29,
January 7 - 21**
MOROCCO



**October 2 - 14,
January 8 - 20**
EGYPT



**June 3 - 16,
January 6 - 19**
COSTA RICA



**July 7 - 20
Sept. 1 - 14**
ENGLAND



July 8 - 29
AUSTRALIA



January 6 - 15
BELIZE



Nov. 11 - 20
BERMUDA



August 2 - 16
BRAZIL



July 26 - Aug. 6
HAWAII



**July 16 - 30,
August 6 - 20**
NOVA SCOTIA



**October 19 - November 4,
January 4 - 20**
INDONESIA



**July 14 - 28,
September 15 - 29**
IRELAND



**June 17 - July 3, July 1 - 17
July 15 - 31,
July 29 - Aug. 14, Aug. 12 - 28**
ALASKA

For Complete Itineraries and Prices, Write or Call:



**June 13 - 29,
June 27 - July 13, July 25 - Aug. 10
October 10 - 26, January 2 - 18**
KENYA



**June 27 - July 16,
July 18 - August 6, October 3 - 22**
CHINA



**June 18 - July 1, July 2 - 15,
July 16 - 29, August 13 - 26,
October 1 - 14, January 7 - 20**
GALAPAGOS ISLANDS



California State University
Dominguez Hills

DIVISION OF EXTENDED EDUCATION

1000 East Victoria Street
Carson, CA 90747
(310) 516-3741

SCH#	COURSE#	SECT	COURSE TITLE	UNITS	DAYS	HOURS	BLDG/RM	INSTRUCTOR	FEE
------	---------	------	--------------	-------	------	-------	---------	------------	-----

SBS D328

ACCOUNTING

(310) 516-3556

= evening classes

MAIL-IN AND FAX REGISTRATIONS NOT ACCEPTED FOR COURSES IN THIS DEPARTMENT

FIRST SESSION

13414	ACC 230	11	FINANCIAL ACNTG	3	MW	# 6:30-10:00 PM	SBS A210	R MAZHIN	\$345
24430	ACC 231	11	MANAGRL ACNTNG	3	TTH	# 6:30-10:00 PM	SBS A210	M AUERBACH	345
44715	ACC 333	11	INCOME TAXATION I	3	MW	# 6:30-10:00 PM	SBS D219	C CHANG	345
04955	ACC 337	11	COST ACCOUNTING	3	TTH	# 6:30-10:00 PM	SBS D219	D BARNETT	345

All Accounting Courses require special approval: See Page 4
ACC 230 PREREQUISITE: INTERMEDIATE ALGEBRA
ACC 231 PREREQUISITE: ACC 230
ACC 333 PREREQUISITE: ACC 230
ACC 337 PREREQUISITE: ACC 231

HFA A111

ART

(310) 516-3310

= evening classes

SECOND SESSION

05191	ART 100	21	LOOKING AT ART	3	TWTH	9:00-12:45 PM	ERC 112	B BAKER	345
-------	---------	----	----------------	---	------	---------------	---------	---------	-----

INTENSIVE

65590	ART 100	61	LOOKING AT ART 06/21 - 07/14	3	TWTH	1:00- 4:45 PM	ERC 112	B BAKER	345
-------	---------	----	---------------------------------	---	------	---------------	---------	---------	-----

SBS G326

BEHAVIORAL SCIENCES

(310) 516-3434

= evening classes

FIRST SESSION

13930	BEH 525	11	MEDIATION	3	MW	# 6:00- 9:45 PM	TBA TBA	R MILLEN	345
32793	BEH 567	11	DEATH & DYING	3	TTH	# 6:00- 9:50 PM	SC E167	S WEEKS	345
56372	BEH 595	11	SPECIAL TOPICS CONFLICT & HEALTH	3	TTH	# 6:00- 9:45 PM	ERC A103	M FEER	345
19246	BEH 595	91	SPECIAL TOPICS CONFLICT & HEALTH	3	TTH	# 6:00- 9:45 PM	TV	M FEER	435

SECOND SESSION

383731	BEH 595	21	SPECIAL TOPICS CONFLICT & COOPERATION	3	TTH	# 6:00- 9:50 PM	SBS D225	M FEER	345
25771	BEH 597S	21	DIRECTED READING	3	TBA	TBA	TBA TBA	F HOSOKAWA	345
71713	BEH 597S	22	DIRECTED READING	3	TBA	TBA	TBA TBA	H CHARNOFSKY	345

BEH 597s PREREQUISITE: BEH 501, BEH 505 AND NINE (9) ADDITIONAL UNITS OF GRADUATE WORK.

NSM A124

BIOLOGY

(310) 516-3381

= evening classes

FIRST SESSION

04384	BIO 102	11	GENERAL BIOLOGY CO-REQ: BIO 102L	3	TTH	9:00-11:30 AM	NSM C213	R GIACOSIE	435
14070	BIO 102L	11	GEN BIOLOGY LAB CO-REQ: BIO 102	0	TTH	12:30- 3:30 PM	NSM B110	R GIACOSIE	0
62694	BIO 120	11	PRIN OF BIOLOGY I CO-REQ: BIO 120L	4	MW	9:00-12:50 PM	NSM D123	D BREST	540
20484	BIO 120L	11	PRIN OF BIO I LAB CO-REQ: BIO 120	0	MW	1:30- 5:00 PM	NSM B110	D BREST	0
43190	BIO 250	11	ELEM ANAT/PHYSL	3	TTH	9:00-12:50 PM	NSM D123	STAFF	345
51811	BIO 251L	11	EL ANAT/ PHYS LAB	1	TTH	1:30- 5:00 PM	NSM C121	STAFF	250
72623	BIO 324	11	MICROBIOLOGY CO-REQ: BIO 324L	3	TTH	9:00-11:30 AM	NSM D129	D SOLEYMANI	495
13193	BIO 324	11	MICROBIOLOGY CO-REQ: BIO 324	0	TTH	12:30-4:30 AM	NSM C129	D SOLEYMANI	495

BIO 250 CO-REQUIREMENT: BIO 251L
BIO 324 CO-REQUIREMENT: BIO 324L

SCH#	COURSE#	SECT	COURSE TITLE	UNITS	DAYS	HOURS	BLDG/RM	INSTRUCTOR	FEE
------	---------	------	--------------	-------	------	-------	---------	------------	-----

SAC 2149

BUSINESS ADMINISTRATION

(310) 516-3465

= evening classes

FIRST SESSION

87441	BUS 445	11	INTNL BUSINESS	3	TTH	# 6:00- 9:30 PM	SBS B215	C LOPILATO	\$345
-------	---------	----	----------------	---	-----	-----------------	----------	------------	-------

SECOND SESSION

60933	BUS 595	21	SEL TOPICS IN BUS SEMINAR IN HUMDY RES.MGT	3	MWTH	# 6:00- 8:30 PM	SBS D121 B	MILLS	345
-------	---------	----	---	---	------	-----------------	------------	-------	-----

ALL BUSINESS COURSES REQUIRE SPECIAL APPROVAL: SEE PAGE 4
BUS 445 PREREQUISITE: FIN 360, MGT 310, AND MRT 350

NSM B202

CHEMISTRY

(310) 516-3376

= evening classes

FIRST SESSION

22680	CHE 102	61	CHEM FOR THE CITIZEN	3	MTWTH	9:00-12:50 PM	NSM C239	U DELACAMP	345
-------	---------	----	----------------------	---	-------	---------------	----------	------------	-----

INTENSIVES

10566	CHE 300	61	ORGANIC CHEMISTRY I	3	MTWTH	10:00-12:15 PM	NSM C221	J LYLE	345
-------	---------	----	---------------------	---	-------	----------------	----------	--------	-----

67852	CHE 300	62	ORGANIC CHEMISTRY I	3	MTWTH	10:00-12:15 PM	NSM C221	T REILLY	345
-------	---------	----	---------------------	---	-------	----------------	----------	----------	-----

04561	CHE 301L	61	ORGANIC CHEM LAB I	1	TWTH	1:00- 4:00 PM	NSM C351	J LYLE	205
-------	----------	----	--------------------	---	------	---------------	----------	--------	-----

00081	CHE 301L	62	ORGANIC CHEM LAB I	1	TWTH	1:00- 4:00 PM	NSM C339	T REILLY	205
-------	----------	----	--------------------	---	------	---------------	----------	----------	-----

59463	CHE 302	61	ORGANIC CHEM II	3	MTWTH	10:00-12:15 PM	NSM C221	J LYLE	345
-------	---------	----	-----------------	---	-------	----------------	----------	--------	-----

83683	CHE 302	62	ORGANIC CHEM II	3	MTWTH	10:00-12:15 PM	NSM C221	T REILLY	345
-------	---------	----	-----------------	---	-------	----------------	----------	----------	-----

81561	CHE 303L	61	ORGANIC CHEM LAB II	1	WTH	1:00- 4:00 PM	NSM C339	J LYLE	205
-------	----------	----	---------------------	---	-----	---------------	----------	--------	-----

75983	CHE 303L	62	ORGANIC CHEM LAB II	1	TWTH	1:00- 4:00 PM	NSM C351	T REILLY	205
-------	----------	----	---------------------	---	------	---------------	----------	----------	-----

06/06 - 06/23
06/06 - 07/11
CO-REQ: CHE 301L
06/06 - 07/11
CO-REQ: CHE 301L
06/06 - 07/07
CO-REQ: CHE 300
06/07 - 07/07
CO-REQ: CHE 300
07/12 - 08/12
CO-REQ: CHE 303L
07/12 - 08/12
CO-REQ: CHE 303L
07/12 - 08/11
CO-REQ: CHE 302
07/12 - 08/11
CO-REQ: CHE 302
CHE 300 PREREQUISITE: CHE 112 OR ONE YEAR OF GENERAL CHEMISTRY
CHE 301 PREREQUISITE: CHE 112 OR ONE YEAR OF GENERAL CHEMISTRY
CHE 302 PREREQUISITE: CHE 300
CHE 303 PREREQUISITE: CHE 300 AND CHE 301

SAC 1166

COMMUNICATIONS

(310) 516-3313

= evening classes

FIRST SESSION

62160	COM 100	11	MASS MEDIA & SOCIETY	3	TTH	1:00 - 4:50 PM	FH C008	L HESS	345
-------	---------	----	----------------------	---	-----	----------------	---------	--------	-----

72483	COM 130	11	FILM CLASSICS	3	TTH	# 6:00 - 9:50 PM	TBA TBA	L LEE	345
-------	---------	----	---------------	---	-----	------------------	---------	-------	-----

88465	COM 250	11	NEWSWRITING/MEDIA	3	TTH	# 6:00 - 9:50 PM	FH B009	L HESS	345
-------	---------	----	-------------------	---	-----	------------------	---------	--------	-----

17290	COM 302	11	LAW / MASS MEDIA	3	MWTH	# 6:00- 8:30 PM	FH C008	R FROHNEN	345
-------	---------	----	------------------	---	------	-----------------	---------	-----------	-----

86236	COM 358	11	COMM GRAPHICS	3	MW	1:00 - 4:50 PM	FH C008	D GUSTAFSON	345
-------	---------	----	---------------	---	----	----------------	---------	-------------	-----

76672	COM 358A	11	COMM GRAPHICS	0	MW	1:00 - 4:50 PM	FH C008	D GUSTAFSON	0
-------	----------	----	---------------	---	----	----------------	---------	-------------	---

63232	COM 397S	11	ON CAMPUS INTERNSHIP	3	TBA	TBA	TBA TBA	D SILVIS	345
-------	----------	----	----------------------	---	-----	-----	---------	----------	-----

31441	COM 496S	11	INTERN COM:	3	TBA	TBA	TBA TBA	D SILVIS	345
-------	----------	----	-------------	---	-----	-----	---------	----------	-----

SECOND SESSION

33412	COM 100	21	MASS MEDIA & SOCIETY	3	MW	9:00-12:50 PM	FH C008	L HESS	345
-------	---------	----	----------------------	---	----	---------------	---------	--------	-----

73006	COM 250	21	NEWSWRITING/MEDIA	3	MW	1:00 - 4:50 PM	FH B009	L HESS	345
-------	---------	----	-------------------	---	----	----------------	---------	--------	-----

16015	COM 358	21	COMM GRAPHICS	3	MW	# 6:00 - 9:50 PM	FH B009	D GUSTAFSON	345
-------	---------	----	---------------	---	----	------------------	---------	-------------	-----

15396	COM 358A	21	COMM GRAPHICS	0	MW	# 6:00 - 9:50 PM	FH C008	D GUSTAFSON	0
-------	----------	----	---------------	---	----	------------------	---------	-------------	---

INTENSIVE

22842	COM 487	61	TV PROD WORKSHOP	3	TTH	4:00 - 5:30 PM	HFA A209	G VINOVICH	345
-------	---------	----	------------------	---	-----	----------------	----------	------------	-----

COM 487 PREREQUISITE: COM 384 AND COM 385

SCH#	COURSE#	SECT	COURSE TITLE	UNITS	DAYS	HOURS	BLDG/RM	INSTRUCTOR	FEE
------	---------	------	--------------	-------	------	-------	---------	------------	-----

SBS A316 COMPUTER INFORMATION SYSTEMS (310) 516-3579

= evening classes

FIRST SESSION

32071	CIS 579	11	INFO SYS POLICY & RES MGT	3	MW	# 6:00- 9:30 PM	SBS E122	P HERNE	\$345
-------	---------	----	------------------------------	---	----	-----------------	----------	---------	-------

NSM A132 COMPUTER SCIENCE (310) 516-3398

= evening classes

FIRST SESSION

16914	CSC 123	11	INT CSC & PRG II CO-REQ: CSC 123A	4	MTWTH	11:30- 1:20 PM	TBA TBA	STAFF	480
65181	CSC 123A	11	INT CSC & PRG II-ACT CO-REQ: CSC 123	0	TTH	2:00- 4:20 PM	SBS A110	STAFF	0
88336	CSC 251	11	C LANG PRG & UNIX	3	MWTH	# 5:30- 8:00 PM	NSM C239	STAFF	360

SECOND SESSION

60760	CSC 111	21	INT COMPUTER & BASIC 3		MTWTH	9:00-10:50 AM	SBS B101	STAFF	360
22746	CSC 121	21	INT CSC & PRG I CO-REQ : CSC 121A	4	MTWTH	11:30- 1:20 PM	SBS B101	STAFF	480
32804	CSC 121A	21	INT CSC & PRG I-ACT CO-REQ : CSC 121	0	MW	2:00- 4:20 PM	SBS A110	STAFF	0

INTENSIVES

23332	CSC 221	61	ASMBLY & INT ORG 06/06 - 08/05	3	MWTH	# 6:15- 7:45 PM	TBA TBA	STAFF	360
18303	CSC 311	61	DATA STRUCTURES 06/06 - 08/05	3	MWTH	9:00-10:30 AM	TBA TBA	STAFF	360
49906	CSC 321	61	PROGRMG LANGUAGES 06/06 - 08/05	3	MWTH	4:30- 6:00 PM	NSM D123	STAFF	360
13042	CSC 341	61	OPERATING SYSTEMS 06/06 - 08/05	3	MWTH	# 6:15- 7:45 PM	NSM D123	STAFF	360
07276	CSC 361	61	SYSTEMS PROGRAMING 06/06 - 08/05	3	MWTH	# 6:15- 7:45 PM	TBA TBA	STAFF	360

CSC PREREQUISITE: MAT 151 OR EQUIVALENT

NSM B202 EARTH SCIENCE (310) 516-3376

= evening classes

INTENSIVE

00744	EAR 100	61	INT EARTH SCIENCES MAY 31 - JUN 16	3	MTWTH	4:00- 7:50 PM	NSM B234	M SCHWARTZ	345
-------	---------	----	---------------------------------------	---	-------	---------------	----------	------------	-----

SBS A326 ECONOMICS (310) 516-3446

= evening classes

FIRST SESSION

55016	ECO 210	11	ECON THEORY 1A MICRO 3	TTH	1:00- 4:50 PM	SBS D215	P TREVEZAS	345
28431	ECO 211	11	ECON THEORY 1B MACRO 3	TTH	#6:00- 9:50 PM	SBS D215	P TREVEZAS	345
81432	ECO 315	11	AMERICAN ECON HISTORY3	TTH	#6:00- 9:50 PM	TBA TBA	F BILLES	345
35991	ECO 494S	61	INDEPENDENT STUDY 3 KENYA STUDY 6/10 - 6/26	M-SU	TBA	TBA TBA	L MOITE	345

SCH#	COURSE#	SECT	COURSE TITLE	UNITS	DAYS	HOURS	BLDG/RM	INSTRUCTOR	FEE
HFA C316			EDUCATION					(310) 516-3519	
HFA C306			GRADUATE EDUCATION					(310) 516-3524	

= evening classes

FIRST SESSION

18141	GED 460	11	INT EXCEP CHILDREN	3	MW	4:00- 7:30 PM	TBA TBA	P PATTERSON	\$345
35733	GED 501	11	SEMINAR IN LEARN & DEV	3	TTH	4:30- 8:20 PM	SBS A216	J JACKSON	345
88454	GED 504	11	EXTMRL PROF SEM	2	M	4:00- 5:50 PM	HFA A348	J PARKER	230
27392	GED 506	11	LAW & ETHICS IN PUB ED	3	TTH	# 6:00- 9:50 PM	SC E149	R VLADOVIC	345
29702	GED 560	11	SPH/LANG DEV	3	MW	# 6:00- 9:50 PM	SBS A216	J JACKSON	345
79450	GED 561	11	DISRD/RDMED DEV PROB OF EXCPT CHILD	3	MW	4:00- 7:30 PM	SBS B209	D OKADA	345
29606	GED 562	11	ADV BEH MGT METH IND SED 3 SPECIAL EDUCATION	3	TTH	4:30- 8:00 PM	TBA TBA	STAFF	345
25373	GED 565	11	CURR INST SEVRLY HNDCP	3	TTH	4:30- 8:00 PM	TBA TBA	P PATTERSON	345
23590	GED 566S	11	DUAL CRED PROG/COHORT 1 PRAC:DIR TCH SEV HNDCP	5	M-S	8:00- 3:00 PM	HFA A348	D OKADA	875
38065	GED 568	11	CURRI INST LRNG HNDICP DUAL CRE.PROG COHORT 1	3	TTH	4:30- 8:00 PM	TBA TBA	K SKINDRUD	345
82386	GED 569S	11	PRAC:DIR TCH LRN HNDCP SPECIAL EDUCATION	5	M-F	8:00- 3:00 PM	TBA TBA	STAFF	875
87566	GED 573	11	POST-ASSESSMNT SEM	1	W	5:00- 5:50 PM	HFA A348	J PARKER	115
48462	GED 582	11	GRP DYNAM PERS GRWTH	3	MW	# 6:00- 9:30 PM	HFA A225	R LEE	345
00781	GED 594S	11	INDEPENDENT STUDY	3	TBA	TBA	TBA TBA	M CONTRERAS	345
20624	GED 594S	12	INDEPENDENT STUDY	1	TBA	TBA	TBA TBA	C BOHMAN	115
00184	GED 594S	13	INDEPENDENT STUDY	2	TBA	TBA	TBA TBA	C BOHMAN	260
85794	GED 594S	14	INDEPENDENT STUDY	3	TBA	TBA	TBA TBA	C BOHMAN	345
37752	GED 597S	11	FIELDWORK COUNSELING	3	T	# 6:00- 9:30 PM	HFA A225	R LEE	525

SECOND SESSION

07221	GED 480	21	ORG SUP PPS SERVICES	3	TTH	5:00- 8:30 PM	HFA A227	T RICHARDSON	345
83451	GED 500	21	RESEARCH METH IN EDU	3	MW	# 6:00- 9:50 PM	HFA A 224	F FISHER	345
16450	GED 503	21	SOC-CULT IN EDUC	3	TTH	4:00- 7:30 PM	HFA A219	M CARRISON	345
82784	GED 508	21	SEM-ISSUES IN EDUC: ETHNIC HERITAGE	3	TTH	7:30-11:00 AM	HFA A223	M CARRISON	345
18712	GED 525	21	BIL/MULT TCH METHODS	3	TTH	4:00 - 7:45PM	FH D003	S MEDINA	345
79100	GED 535	21	INTRO COMPUTERS IN EDU	3	MW	1:00 - 4:30 PM	SC E153	P DESBERG	360
42700	GED 559S	21	GEN PRAC EXCEPT CHILD	4	MW M-S	2:00 - 4:30 PM 8:00 -12:30 PM	ERC E139 HFA A348	D OKADA	700
34451	GED 562	21	ADV BEH MGT METH IND SED 3 SPECIAL EDUCATION	3	TTH	4:30 - 8:00 PM	SBS F121	STAFF	345
61541	GED 594S	21	INDEPENDENT STUDY	1		TBA	TBA TBA	C BOHMAN	115
41716	GED 594S	22	INDEPENDENT STUDY	2		TBA	TBA TBA	C BOHMAN	230
81550	GED 594S	23	INDEPENDENT STUDY	3		TBA	TBA TBA	C BOHMAN	345
09973	GED 596S	21	ADV INTRN IN SCH ADM	3	T	4:00- 5:50 PM	HFA A348	J PARKER	345
02881	GED 596S	22	ADV INTERN IN SCH ADM	3	T	# 6:00- 8:50 PM	HFA A348	J PARKER	345
46970	GED 597S	21	FIELDWORK COUNSELING	3		TBA	TBA TBA	M CONTRERAS	345
42280	GED 598S	21	FIELD WK SCHOOL PSYCH	3	TH	3:30- 4:30 PM INTENSIVE S	HFA A348	T RICHARDSON	525
86682	GED 507	61	SPEC ED: RESCH & TRNDS 06/08 - 8/18	3	M-F	12:30- 5:30 PM	HFA A219	L DINGMAN	345
68821	GED 513	61	CHILDREN'S LITERATURE 06/28 - 07/14	3	TWTH	8:30- 1:00 PM	HFA A228	C BOHMAN	345

GED 460 PREREQUISITE: TED 305 AND TED 402

GED 501, GED 503, GED 513 PREREQUISITE: CONSENT OF INSTRUCTOR AND GRADUATE SCHOOL STAMP

GED 562 PREREQUISITE: GED 460, CONSENT OF INSTRUCTOR AND GRADUATE SCHOOL STAMP

GED 582 PREREQUISITE: CONSENT OF INSTRUCTOR AND GRADUATE SCHOOL STAMP

GED 594 PREREQUISITE: INDEPENDENT STUDY AND GRADUATE SCHOOL STAMP

GED 597 PREREQUISITE: ALL PPS COURSES MUST BE COMPLETED OR FINAL COURSES CAN BE TAKEN WITH FIELDWORK

SCH#	COURSE#	SECT	COURSE TITLE	UNITS	DAYS	HOURS	BLDG/RM	INSTRUCTOR	FEE
------	---------	------	--------------	-------	------	-------	---------	------------	-----

HFA C308

TEACHER EDUCATION

(310) 516-3522

= evening classes

SECOND SESSION

80345	TED 305S	21	INT TO CLASS RM TEACH	1	M	8:00- 9:00 AM	HFA B303	P ELLIS	\$115
59290	TED 305S	22	INT TO CLASS RM TEACH	1	M	12:00- 1:00 PM	HFA B303	P ELLIS	115
11631	TED 305S	23	INT TO CLASS RM TEACH	1	M	5:00- 6:00 PM	HFA B303	P ELLIS	115
50094	TED 402	21	MOTIVATION & LRNING	3	MW	5:00- 8:30 PM	SC E167	P DESBERG	345
32701	TED 403	21	TCHNG WHOLE LANG:	3	MW	5:00- 8:30 PM	HFA A221	J LALAS	345
45124	TED 405	21	MAINSTREAM CH/	3	MW	5:00- 8:30 PM	SBS B137	C LEVITON	345
49232	TED 406	21	TEACHING SECONDARY	3	TTH	5:00- 8:30 PM	HFA A221	STAFF	345
30435	TED 407	21	READING TCHG METH BILINGUAL	3	TTH	5:00- 8:30 PM	HFA A229	L NARES	345
05773	TED 410	21	BICULT EDU ELEM MATH & SCIENCE	3	MW	9:00- 1:00 PM	SBS B110	L NEUBERGER	345
02155	TED 467	21	TEACH METH I: SECNDRY	3	TTH	1:00- 4:30 PM	HFA A324	S PRESCOTT	345
27322	TED 494S	21	INDEPENDENT STUDY	1	TBA	TBA	TBA TBA	K TAIRA	115
73780	TED 494S	22	INDEPENDENT STUDY	2	TBA	TBA	TBA TBA	K TAIRA	230
76532	TED 494S	23	INDEPENDENT STUDY	3	TBA	TBA	TBA TBA	K TAIRA	345

INTENSIVES

56711	TED 304	61	FOUNDATIONS IN ED	1	S	9:00- 2:00 PM	SBS F225	S GEMMELL	115
51590	TED 304	62	06/04,11&18 FOUNDATIONS IN ED	1	MW	1:30- 3:45 PM	SBS B110	STAFF	115
36481	TED 304	63	06/27 - 07/18 FOUNDATIONS IN ED	1	S	9 :00- 2:00 PM	SBS B110	STAFF	115
83090	TED 402	61	08/06 13,20 MOTIVATION & LRNING	3	TWTH	4:00- 8:45 PM	HFA A224	STAFF	345
23962	TED 402	62	06/7 - 06/23 MOTIVATION & LRNING	3	TTH	5:00- 9:00 PM	HFA A223	STAFF	345
59614	TED 403	61	06/28 - 07/28 TCHNG WHOLE LANG:	3	TWTH	4:00- 8:45 PM	HFA A229	C MCDERMOTT	345
32266	TED 403	62	READ/LA 06/07 - 06/23 TCHNG WHOLE LANG:	3	TTH	9:00- 1:15 PM	HFA A224	STAFF	345
07943	TED 405	61	READ/LA 06/28 - 07/28 MAINSTREAM CH/	3	TWTH	4:00- 8:45 PM	HFA A228	D WOLFF	345
24780	TED 405	62	SPEC NEED 06/07-06/23 MAINSTREAM CH/	3	TWTH	4:00- 8:45 PM	HFA A228	D WOLFF	345
73625	TED 406	61	SPEC NEED 07/05 -21 TCHNG 2NDARY READING	3	TWTH	4:00- 8:45 PM	TBA TBA	H FERGUSON	345
14346	TED 407	61	06/07-06/23 TCHG METH BIL/ BICULT EDU	3	TWTH	4:00- 8:45 PM	HFA A228	L NARES	345
36982	TED 408	61	06/07-06/23 ELEM METHODS	2	MW	4:00- 8:30 PM	SBS A144	STAFF	230
31640	TED 408	62	IN ART/MUSIC 06/06 - 22 ELEM METHODS	2	TTH	4:30- 8:30 PM	SBS A144	STAFF	230
06510	TED 409A	61	IN ART/MUSIC 06/28 - 07/21 ELEM METHODS	1	TTH	4:00- 8:30 PM	GYM A104	STAFF	140
27300	TED 409A	62	IN PHY EDUC 06/07 - 23 ELEM METHODS	1	MW	4:30- 8:00 PM	GYM A104	STAFF	140
09170	TED 410	61	IN PHY EDUC 06/27 - 07/25 ELEM MATH & SCIENCE	3	MW	4:30- 9:00 PM	HFA A223	C WATKINS	345
26740	TED 412	61	06/27 - 07/27 EL SOC STUD/CONT	2	MW	4:00- 8:30 PM	HFA A223	H FERGUSON	230
66975	TED 412	62	READ WRIT 06/06 -22 EL SOC STUD/CONT	2	MW	1:30- 4:30 PM	SBS G122	STAFF	230
31570	TED 412	63	READ WRIT 06/27 - 07/27 EL SOC STUD/CONT	2	TTH	5:00- 8:30 PM	HFA A224	STAFF	230
28210	TED 415	61	READ WRIT 06/28 - 07/26 MULTIC PERSPECTIVE	2	TTH	4:00- 8:30 PM	HFA A223	STAFF	230
05401	TED 415	62	TCHRS 06/07 -23 MULTIC PERSPECTIVE	2	TTH	1:30- 4:30 PM	HFA A229	STAFF	230
52286	TED 415	63	TCHRS 06/28 - 07/26 MULTIC PERSPECTIVE	2	TWTH	9:00- 1:30 PM	HFA A223	STAFF	230
25631	TED 420	61	TCHRS 08/9 -18 COMPUTER LIT	1	S	9:00- 2:00 PM	SC E139	N MACH	230
77700	TED 420	62	FOR TEACHERS 06/04 ,11&25 COMPUTER LIT	1	S	9:00- 2:00 PM	ERC A121	STAFF	230
15050	TED 494S	61	FOR TEACHERS 07/09 -16&23 INDEPENDENT STUDY	1	TBA	TBA	TBA TBA	K TAIRA	115
79660	TED 494S	62	INDEPENDENT STUDY	2	TBA	TBA	TBA TBA	K TAIRA	230
77755	TED 494S	63	INDEPENDENT STUDY	3	TBA	TBA	TBA TBA	K TAIRA	345

TED 305s PREREQUISITE: REQUIRES 30 HOURS OF CLASSROOM OBSERVATIONS
 TED 420 WILL SATISFY COMPUTER LITERACY REQUIREMENT ONLY IF STUDENT ENROLLED IN FULL CSUDH CREDENTIAL PROGRAM. ALL OTHERS MUST TAKE GED 535 AND 535L, CREDIT OR NO CREDIT ONLY.

SUMMER HIGHLIGHTS

ONE YEAR OF ORGANIC CHEMISTRY IN A SINGLE SUMMER

Designed for premedical and pre-dental students, this ten-week program corresponds to a full year of organic chemistry with lab. The two sequential courses offer 8 semester units the required chemistry for professional schools. The course is helpful in preparing for the DAT and MACT. **Students who enroll for the entire 10 week program will have priority registration.**

Upper Division

CHE 300 Organic Chemistry I (3) (Summer Only).

Prerequisite: CHE 112 or 1 year of general Chemistry

A detailed study of organic molecular structure, reaction mechanisms stereochemistry, and synthesis with emphasis on aliphatic and aromatic systems. Three hours of lecture per week.

CHE 301 Organic Chemistry Laboratory I (1) (Summer Only).

Prerequisites: CHE 112 or 1 year of general chemistry; concurrent enrollment in CHE 300.

Basic experimental techniques of organic chemistry. Three hours of laboratory per week.

CHE 302 Organic Chemistry II (3) (Summer Only).

Prerequisites: CHE 300 and CHE 301. Concurrent enrollment in CHE 303.

Continuation of CHE 300 with emphasis on the chemistry of organic compounds containing oxygen and nitrogen. Three hours of lecture per week.

CHE 303 Organic Laboratory II (1) (Summer Only).

Prerequisites: CHE 112 or 1 year of general chemistry; concurrent enrollment in CHE 302.

Preparation of organic compounds and qualitative organic analysis. Three hours of laboratory per week.

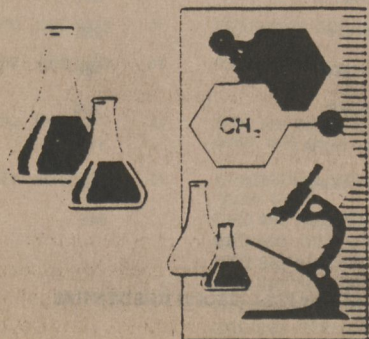

Courses Offered During Summer Session '94

GENERAL STUDIES LIBERAL STUDIES SCHOOL OF MANAGEMENT

ART 100	MAT 151	ART 100	HUM 314	ACC 230	MGT 310
BIO 102	MAT 171	BIO 102	MAT 107	ACC 231	MGT 312
CHE 102	MAT 191	ECO 315	MAT 207	ACC 333	MGT 490
COM 130	MAT 193	ENG 308	PHI 120	BUS 445	PUB 301
ENG 110	PHI 120	ENG 314	PSY 350	BUS 595	PUB 508
ENG 111	PSY 101	ENG 350	SBS 318	CIS 579	PUB 510
HUM 200	SOC 102	HIS 110	SMT 314	FIN 360	
MAT 105	THE 120	HIS 301	SOC 331	FIN 480	
		HUM 310	THE 120		

HEALTH IN PUBLIC EDUCATION

HEA 300-61

PAMELA KROCHALK

JUNE 6 - JULY 16

Health Education is a required course for professional multiple or single subject clear credential teaching applicants. The course covers all topics designated in the Health Framework for California including nutrition, the physiological and sociological effects of substance abuse, cardiopulmonary resuscitation, and child abuse.

The primary function of this course is to enhance the school teacher's ability to promote positive health behavior among their students. The course will review current health issues, identify appropriate grade level teaching methods to promote positive health behaviors, identify community and school health resources, review legal issues, and provide CPR certification. Included in this course will be directed teaching activities, individual/group presentations and cooperative learning activities.



GED 508 SEMINAR IN EDUCATION: African American Heritage for Education

This 3-unit independent study course, taught by Muriel Carrison, fulfills LAUSD (& surrounding districts) salary step reqs. for a 3-unit course on a specific ethnic group. Students may select Mexican American, Vietnamese American, and other ethnicities while they explore traditions, politics, past & current coping mechanisms, current legislation, leaders and personalities. Class meets as a group in 1st week to plan projects, thereafter to discuss progress.

SEE EDUCATION LISTINGS

ART 100: LOOKING AT ART ART FOR TEACHERS

Don't be intimidated by art. Through the use of games, visual aids, and activities you will enjoy and understand art -- and be able to share this with your students in your own classes. This is a low stress, high fun class meant to provide an enjoyable art learning experience. You will learn: crucial art fundamentals, common media, significant artists and art periods, plus how to view and appreciate a work of art.

This 3-unit class satisfies the general education requirement liberal studies waiver, and is a professional growth opportunity.

SEE ART LISTINGS

SUMMER HIGHLIGHTS

A 10-Day travel/study program in

Turkey

July 1 - 11, 1994

\$1975*

Double occupancy (single supplement, \$125). Includes airfare, 3 units California State University credit, hotel accommodations, 3 meals daily and all excursions within Turkey.

**price subject to change*

The city of Denizli will be your base in Turkey. Amid ancient ruins of Anatolian, Greek and Roman civilizations, it's a fascinating place for students of history. You'll also see sights not usually featured in commercial tours such as remote villages and wilderness areas of great interest to those in ecological, environmental and social studies. There will be plenty of fun—visiting seaside resorts with breathtaking scenery on the Aegean/Mediterranean coast within view of the Greek Islands, opportunities to sample night life — dancing and shopping — will also be available.

Explore the fascinating terrain, wonder at the ancient civilizations and get to know the warm people of Turkey by taking advantage of this unique travel-study opportunity! Space is limited, reserve now!

For more information call the:
Office of Extended Education
(310) 516-3741

LIVE ON CAMPUS THIS SUMMER!

Expanded housing facilities on the CSUDH campus now allow those attending Summer Session courses, seminars and the American Language and Culture Program to stay conveniently on campus.

Space is limited. Make reservations as soon as possible.

Deposit required. For more information, contact Andy Klingelhofer, (310) 516-4228

HUMANITIES

Humanities Department courses offer several opportunities to satisfy requirements while exploring fascinating subject matter. For example,

HUM 310-11 and 61 Key Concepts: Propaganda & Film (3)

Instructor: W. Wells; G. Vinovich

Prerequisite: HUM 200

Film and literature are used as propaganda weapons to persuade, frighten, justify, entertain, and instruct audiences in every part of the globe. Course uses a variety of politically oriented films and essays to broaden students' artistic, aesthetic, and political history perspectives.

HUM 314-12 Key Issues: French Perspectives: Enlightenment (3)

Instructor: C. Caloia

The 18th century in general, but in France in particular, is commonly known as the Age of the Enlightenment. A new light was shed on the man's thinking about the arts & sciences, about his personal & social relations, about the purpose of his existence, and about the kind of social and political institutions required to realize it. The changes this thinking brought about were immense—and how they affect us today will be addressed in this course.

HUM 314-21 Key Issues: Imaginative The Views Of Choice

Instructor: M Shafer

Imaginative views of the choices between right and wrong, also from the point of view of the reporter about the Holocaust Morality.

HUM 314-11 Key Issues: International Film: Art/Image/Reality

Instructor: L. Lee

International Film is not only a purveyor of culture for its national and international viewers but a vehicle for observing the intricate of the philosophical and sociological and artistic reality of various language groups. A view beyond the celluloid can be most revealing- come look!



HFA E315

ENGLISH

(310) 516-3322

= evening classes

FIRST SESSION

25071	ENG 110	11	FRESHMAN COMP I	3	MW	9:00-12:50 PM	HFA A22	R WINSTON	\$ 230
77840	ENG 111	11	FRESHMAN COMP II	3	MW	1:00- 4:50 PM	HFA A230	S WATERWORTH	230
58306	ENG 314	11	ENGLISH SYNTAX	3	TTH	# 6:00- 9:50 PM	SBS B101	K ZOU	230
48042	ENG 325	11	POETRY	3	MW	1:00- 4:50 PM	HFA A221	M SHAFER	230
31080	ENG 350	11	ADVANCED COMP	3	MW	# 6:00- 9:50 PM	HFA A230	M SHAFER	230
17032	ENG 350	12	ADVANCED COMP	3	TTH	1:00- 4:50 PM	1703 2	L SMITH	230
68106	ENG 352	11	WRIT SPKG SKILLS MGMT	3	TTH	1:00- 4:50 PM	SBS B110	W WELLS	230
19784	ENG 494S	11	INDEPENDENT STUDY	1	TBA	TBA	TBA TBA	STAFF	115
55414	ENG 494S	12	INDEPENDENT STUDY	2	TBA	TBA	TBA TBA	STAFF	230
68515	ENG 494S	13	INDEPENDENT STUDY	3	TBA	TBA	TBA TBA	STAFF	345
20985	ENG 590	11	SEMINAR IN LITERATURE NOVELS OF JOHN BARTH	3	TTH	# 6:00- 9:50 PM	HFA A230	S WATERWORTH	345
33865	ENG 594S	11	INDEPENDENT STUDY	1	TBA	TBA	TBA TBA	STAFF	115
12515	ENG 594S	12	INDEPENDENT STUDY	2	TBA	TBA	TBA TBA	STAFF	230
44284	ENG 594S	13	INDEPENDENT STUDY	3	TBA	TBA	TBA TBA	STAFF	345

SECOND SESSION

31592	ENG 308	21	CRIT APPR CHILD LIT	3	TTH	1:00- 4:50 PM	HFA A230	S WATERWORTH	345
35232	ENG 326	21	PROSE FICTION	3	TTH	# 6:00- 9:50 PM	SBS A204	T GIANNOTTI	230
55683	ENG 350	21	ADVANCED COMP	3	TTH	1:00- 4:50 PM	SBS E122	T GIANNOTTI	230
25712	ENG 352	21	WRIT SPKG SKILLS MGMT	3	TTH	# 6:00- 9:50 PM	HFA A219	M C MURRAY	345
01293	ENG 494S	21	INDEPENDENT STUDY	1	TBA	TBA	TBA TBA	STAFF	115
38765	ENG 494S	22	INDEPENDENT STUDY	2	TBA	TBA	TBA TBA	STAFF	230
85481	ENG 494S	23	INDEPENDENT STUDY	3	TBA	TBA	TBA TBA	STAFF	345
33740	ENG 594S	21	INDEPENDENT STUDY	1	TBA	TBA	TBA TBA	STAFF	115
55915	ENG 594S	22	INDEPENDENT STUDY	2	TBA	TBA	TBA TBA	STAFF	230
10964	ENG 594S	23	INDEPENDENT STUDY	3	TBA	TBA	TBA TBA	STAFF	345

ENG 110 PREREQUISITE: ENGLISH PLACEMENT TEST T-SCORE ABOVE 150 OR TEST SCORE EXEMPTION,
SUCCESSFUL COMPLETION OF 099 AND/OR SUCCESSFUL COMPLETION OF ENGLISH 088 FOR STUDENTS WITH EPT SCORES
BELOW T-150.

ENG 111 PREREQUISITE: ENG 110 OR EQUIVALENT

ENG 314 PREREQUISITE: ENG 111

ENG 350 PREREQUISITE: 111 OR EQUIVALENT

ENG 352 PREREQUISITE: ENG 111 AND SATISFYING THE GRADUATE COMPETENCY IN WRITING REQUIREMENT: GWE SCORE OF
7 OR BETTER OR CERTIFICATION WRITING COURSE SUCH AS ENG 350

SBS D324

FINANCE

(310) 516-3501

= evening classes

FIRST SESSION

54025	FIN 360	11	BUSINESS FINANCE	3	MW	9:15-12:45 PM	SBS A210	T BURROWS	345
78422	FIN 360	12	BUSINESS FINANCE	3	TTH	# 6:00- 9:30 PM	SBS B137	R ULIVI	345
30796	FIN 480	11	ECON OF THE FIRM	3	MW	1:00- 4:30 PM	SBS B203	H MILGRIM	345

MAIL-IN AND FAX REGISTRATION NOT ACCEPTABLE FOR COURSES IN THIS DEPARTMENT

FIN COURSES REQUIRE SPECIAL APPROVAL

FIN 360 PREREQUISITE: ACC 230, ECO210 AND MAT 171

FIN 480 PREREQUISITE: ECO 210, ECO 211 AND QMS 321

SCH#	COURSE#	SECT	COURSE TITLE	UNITS	DAYS	HOURS	BLDG/RM	INSTRUCTOR	FEE
------	---------	------	--------------	-------	------	-------	---------	------------	-----

SHC A141

HEALTH SCIENCE

(310) 516-3818

= evening classes

FIRST SESSION

88922	HEA 495	11	SPEC TPCS IN HEA SC	3	TTH	# 6:00- 9:50 PM INTENSIVE	ERC C112	E WELLS	\$345
50466	HEA 300	61	HEALTH IN PUB ED 06/28 - 7/16	3	TTHF SSU	# 6:00 - 9:45 PM 9:00 -11:45AM	SBS B131 SBS B131	P KROCHALK	345

SBS A326

HISTORY

(310) 516-3446

= evening classes

FIRST SESSION

60863	HIS 101	11	HISTORY OF THE WORLD	3	TWTH	2:00 -4:30PM	SBS B101	R PERKINS	345
82272	HIS 110	11	WESTRN WRLD:CLASSICAL	3	MW	9:00-12:50 PM	SBS D215	C UDEZE	345
28114	HIS 301	11	IND FAM & COM HIS PERSP	3	TWTH	# 6:00- 8:30 PM	SBS E116	R PERKINS	345

HFA E 303

HUMANITIES

(310) 516-3451

= evening classes

FIRST SESSION

84744	HUM 200	11	INTRO TO HUMANITIES	3	MW	9:00-12:50 PM	HFA A230	P RODNEY	345
17872	HUM 310	11	KEY CONCEPTS FILM & PROPAGANDA	3	TTH	9:00- 1:00 PM	SBS B110	W WELLS	345
10183	HUM 314	11	KEY ISSUES INT'L FILM:ART/IMAGE REA	3	MW	# 6:00- 9:50 PM	HFA A103	L LEE	345
70545	HUM 314	12	KEY ISSUES FRENCH PERSP/ENLGTMENT	3	MW	9:00-12:50 PM	HFA A221	C CALOIA	345

SECOND SESSION

76742	HUM 200	21	INTRO TO HUMANITIES	3	MW	9:00- 2:50 PM	HFA A230	P RODNEY	345
01853	HUM 314	21	KEY ISSUES ETHICAL HUMANITY	3	TTH	9:00-12:50 PM	HFA A221	M SHAFER	345

INTENSIVES

17161	HUM 310	61	KEY CONCEPTS FILM PROPAGANDA 06/7 - 06/30	3	TWTH	# 6:00-10:00 PM	HFA A103	G VINOVICH	345
60270	HUM 312	61	KEY MOVEMENTS: HARLEM RENAISSANCE	3	MTWTH	9:00 - 12:45 PM	SC E167	J JOHNSON	345

SBS B232

INTERDISCIPLINARY STUDIES

(310) 516-3649

= evening classes

FIRST SESSION

07033	IDS 255	11	LANG & METH OF SCI (PACE)	3	TTH	# 6:00-10:00 PM	TBA TBA	D BREST	345
61622	IDS 330	11	INTRDIS TOP INDSTRL REV	3	MW	# 6:00-10:00 PM	TBA TBA	STAFF	345
42954	IDS 350	11	INTERD TOP SCI, TECH & SOC THE GREENHOUSE EFFECT	3	MW	# 6:00-10:00 PM	TBA TBA	D BREST	345

SBS D322

MANAGEMENT

(310) 516-3551

= evening classes

FIRST SESSION

35070	MGT 310	11	MANAGEMENT THEORY	3	MW	9:00 - 12:50 PM	SBS G126	B CHRISPIN	345
46126	MGT 312	11	ORGANIZATIONAL BEHAVIOR	3	TTH	9:00-12:50 PM	SBS G122	B CHRISPIN	345
16936	MGT 490	11	STRATEGIC MANAGEMENT SEMIN	3	TTH	# 6:00- 9:50 PM	SBS E122	R DOWLING	345
68622	MGT 590	11	SEM IN STRATEGIC MGMT	3	MWTH	# 6:00- 8:30 PM	SBS B203	M BLYN	345

SCH#	COURSE#	SECT	COURSE TITLE	UNITS	DAYS	HOURS	BLDG/RM	INSTRUCTOR	FEE
------	---------	------	--------------	-------	------	-------	---------	------------	-----

SBS G322

MARRIAGE & FAMILY COUNSELING

(310) 516-3435

= evening classes

FIRST SESSION

58881	MFC 576	11	HUMAN COMMUNICATION 3	TTH	1:00- 4:50 PM	SBS B209	H CHARNOFSKY	\$345
87006	MFC 580	11	CRSS-CUL FAM VAL & BEH 3	TTH	# 6:00- 9:50 PM	SBS B209	H CHARNOFSKY	345

NSM A132

MATHEMATICS

(310) 516-3378

= evening classes

FIRST SESSION

17323	MAT 005X	11	ELEM ALG & GEOM 3	MWTH	9:00-11:30 AM	TBA TBA	STAFF	345
23833	MAT 005X	12	ELEM ALG & GEOM 3	MWTH	1:00- 3:30 PM	TBA TBA	STAFF	345
19320	MAT 009	11	ALGEBRA 3	MWTH	1:00- 3:30 PM	TBA TBA	STAFF	345
38371	MAT 009	12	ALGEBRA 3	MWTH	# 6:00- 8:30 PM	TBA TBA	STAFF	345
16310	MAT 105	11	FINITE MATHEMATICS 3	MW	# 6:00- 9:50 PM	TBA TBA	W ARMACOST	345
38054	MAT 131	11	ELEM STAT & PRBILTY 3	TTH	9:00-12:50 PM	TBA TBA	STAFF	345
74793	MAT 151	11	PRE-CALC MATH 3	TTH	# 6:00- 9:50 PM	TBA TBA	G KALLO	345
19445	MAT 171	11	CALC FOR MGT LIFE SCI 4	MWTH	9:00-12:20 PM	TBA TBA	S MOITE	460

SECOND SESSION

59872	MAT 005X	21	ELEM ALG & GEOM 3	MWTH	# 9:00-11:30 AM	SBS E126	STAFF	345
56770	MAT 005X	22	ELEM ALG & GEOM 3	MWTH	# 6:00- 8:30 PM	TBA TBA	STAFF	345
85164	MAT 009	21	ALGEBRA 3	MWTH	# 9:00-11:30 AM	TBA TBA	STAFF	345
26014	MAT 009	22	ALGEBRA 3	MWTH	# 6:00- 8:30 PM	TBA TBA	STAFF	345
09903	MAT 105	21	FINITE MATHEMATICS 3	MW	9:00-12:50 PM	TBA TBA	STAFF	345
61235	MAT 105	22	FINITE MATHEMATICS 3	TTH	#6:00- 9:50 PM	TBA TBA	S BOOK	345
50643	MAT 107	21	FOUNDATION REAL NUM SYST	TTH	5:00- 8:50 PM	TBA TBA	J WILKINS	345
63372	MAT 131	21	ELEM STAT & PRBBLTY 3	MW	# 6:00- 9:50 PM	TBA TBA	STAFF	345
78890	MAT 171	21	CALC FOR MGT LIFE SCI 4	TWTH	# 6:00- 9:20 PM	TBA TBA	S MOITE	460
16995	MAT 191	21	CALCULUS I 4	MTWTH	#9:00-11:30 PM	TBA TBA	STAFF	460
76683	MAT 193	21	CALCULUS II 4	MTWTH	#9:00-11:30 PM	TBA TBA	STAFF	460
38916	MAT 207	21	FUNDMNTLS / GEOM 3	TWTH	5:00- 8:50 PM	TBA TBA	H ANDERSON	354
42744	MAT 281	61	DISCRETE MATHEMATICS 3	MWTH	11:00 - 12:30 PM	SBS F121	C WILLIAMS	345
25513	MAT 497S	21	INDEPENDENT STUDY 3	TBA	TBA	TBA TBA	STAFF	345

ALL MATH COURSES REQUIRE ELM APPROVAL FROM MATH DEPARTMENT
 MAT 105 PREREQUISITE: FULFILLMENT OF THE ELM REQUIREMENT
 MAT 131 PREREQUISITE: MAT 005 OR ONE YEAR OF HIGH SCHOOL ALGEBRA
 MAT 171 PREREQUISITE: MAT 009 OR EQUIVALENT WITH A GRADE OF "C" OR BETTER
 MAT 191 PREREQUISITE: MAT 191 OR EQUIVALENT WITH A GRADE OF "C" OR BETTER

HFA A342

PHILOSOPHY

(310) 516-3328

= evening classes

FIRST SESSION

53060	PHI 120	11	CRITICAL REASONING 3	MTW	11:30 - 2:00 PM	ERC G152	D DOCKSTADER	345
-------	---------	----	----------------------	-----	-----------------	----------	--------------	-----

SCH#	COURSE#	SECT	COURSE TITLE	UNITS	DAYS	HOURS	BLDG/RM	INSTRUCTOR	FEE
------	---------	------	--------------	-------	------	-------	---------	------------	-----

NSM B202

PHYSICS

(310) 516-3591

= evening classes

FIRST SESSION

77615	PHY 108	11	PHYSICAL SCIENCE II CO-REQ: PHY 108L	3	TTH	4:00- 6:30 PM	NSM C213	K LEE	\$ 435
53476	PHY 108L	11	PHYS SCI II LAB CO-REQ: PHY 108	0	TTH	# 6:15- 9:40 PM	NSM C243	K LEE	0

INTENSIVES

17264	PHY 120	61	ELEM OF PHYSICS I 06/13 - 07/14 CO-REQ: PHY 120L	4	MTWTH	10:00-12:15 PM	NSM B252	M SHARIFIAN-ATTAR	560
67454	PHY 120L	61	ELEM OF PHYSICS I 06/13 - 07/14 CO-REQ: PHY 120	0	MTWTH	12:30- 2:30 PM	NSM B242	M SHARIFIAN-ATTAR	0
17953	PHY 122	61	ELEM OF PHYSICS II 07/18 - 08/18 CO-REQ: PHY 122L	4	MTWTH	10:00-12:15 PM	NSM B252	M SHARIFIAN-ATTAR	560
89342	PHY 122L	61	ELEM OF PHY II LAB 07/18 - 08/05 CO-REQ: PHY 122	0	MTWTH	12:30- 2:30 PM	NSM B242	M SHARIFIAN-ATTAR	0

PHY 120 PREREQUISITE: HIGH SCHOOL OR COLLEGE ALGEBRA, CO-REQUIREMENT PHY 120 LAB
PHY 122 PREREQUISITE: PHY 120, CO-REQUIREMENT: PHY 122 LAB

SBS G 326

POLITICAL SCIENCE

(310) 516 - 3434

= evening classes

FIRST SESSION

49442	POL 340	11	POL CHANGE 1ST 3RD WORLDS	3	TTH	9:00-12:50 PM	SBS A210	H SALHI	345
55532	POL 346	11	GOV & POL OF RUS/COMWLTH		MWF	9:00-11:30 PM	SBS G122	H SALHI	345
25911	POL 312	21	STATE & LOCAL GOV ORGANIZATION & PROBLEMS	3	MW	1:00 - 4:50 PM	SBS A210	H SALHI	345

SECOND SESSION

SBS A336

PSYCHOLOGY

(310) 516-3427

= evening classes

FIRST SESSION

85750	PSY 363	11	ABNRML PERSONALITY	3	MW	1:00- 4:50 PM	SBS E122	A HASS	345
48930	PSY 415	11	ADV RES METH H HUM INFO PROC STU.ENRL.BOTH	3	MW	9:00-12:50 PM	SBS B203	L ROSEN	345
84991	PSY 416	11	RES SEM INFO PROC STU.ENRL.BOTH PSY415/416	3	TTH	9:00-12:50 PM	SBS B203	L ROSEN	345

SECOND SESSION

56453	PSY 101	21	GEN ST: HUM BEH	3	TWTH	2:00- 4:30 PM	SBS D225	L GRAY-SHELLBERG	345
19574	PSY 235	21	INT RESEARCH METH CO-REQ: PSY 235L	3	MW	4:00- 10:00 PM	SBS D215	STAFF	375
21512	PSY 235L	21	INT RESEARCH METH CO-REQ: PSY 235	0	MW	4:00- 10:00 PM	SBS A232	STAFF	0
01956	PSY 464	21	INT CLINICAL PSYCH	3	TTH	1:00- 4:50 PM	SBS G121	J TODD	345
29293	PSY 563	21	SEM INAR IN PSYCHOPATHOLOGY	3	MW	# 6:30-10:20 PM	SBS F121	A BOHART	345
66603	PSY 567	21	INDIVIDUAL ASSESSMENT CO-REQ: PSY 567A	3	TTH	5:00- 8:50 PM	SBS B110	J TODD	0
17426	PSY 567A	21	INDIVIDUAL ASSESSMENT	0	TTH	5:00- 8:50 PM	SBS B110	J TODD	0

INTENSIVES

27742	PSY 305	61	HISTORY & SYSTEMS OF PSYCHOLOGY 06/06 - 0/6/23	3	MTWTH	9:00-12:50 PM	SBS A232	L GRAY-SHELLBERG	345
-------	---------	----	---	---	-------	---------------	----------	------------------	-----

SCH#	COURSE#	SECT	COURSE TITLE	UNITS	DAYS	HOURS	BLDG/RM	INSTRUCTOR	FEE
08186	PSY 340	61	SOCIAL PSYCH: 06/06 - 06/23	3	MTWTH	5:00- 8:50 PM	SBS A204	S SANTOS	\$345
59636	PSY 350	61	PSYCH PERSP DEVLPMNTL PSYCH 06/06 - 06/23	3	MTWTH	1:00- 4:50 PM	SBS A204	D HENSCHER	345
49372	PSY 360	61	THEORIES/PERSONALITY 3 06/27 - 07/15		MTWTH	9:00-12:50 PM	SBS D225	L GRAY-SHELLBERG	345

SBS D311

PUBLIC ADMINISTRATION

(310) 516-3444

= evening classes

FIRST SESSION

32653	PUB 301	11	ADMIN LEADERSHIP & BEH 3	MW	# 6:00- 9:55 PM	SBS B101	J BELL	345
51774	PUB 508	11	SEM: PUB PERSONEL LABOR REL	MW F	# 6:00- 9:45 PM 8:30- 4:00 PM	SBS A104 TBA TBA	J BELL	345

INTENSIVE

66150	PUB 510	61	SEM: PUBLIC FIN MGT 06/6 - 08/03 500-LEVEL PUB COURSES REQUIRE SPECIAL APPROVAL PUB 508 PREREQUISITE: PUB 500 PUB 510 PREREQUISITE: PUB 500	MWF	# 6:00- 9:30 PM	SBS B231	J SMITH	345
-------	---------	----	---	-----	-----------------	----------	---------	-----

NSM C101

QUALITY ASSURANCE

(310) 516-3880

FIRST SESSION

= evening classes

56313	QAS 516	11	MEASURE & TEST TCHNIQ 3	TTH	# 7:00-10:00 PM	TBA TBA	E WATSON	345
19891	QAS 520	11	QUALITY COST & SUPPL EVALU	TTH	# 6:00-9:00 PM	TBA TBA	B TRAPP	345
22315	QAS 530	11	SRC FOR SERVICE PROF OFF-CAMPUS, ANAHIEM	TTH	# 6:00-9:00 PM	TBA TBA	J SPEER	390

SBS D324

QUANTITATIVE METHODS

(310) 516-3501

= evening classes

FIRST SESSION

83484	QMS 321	11	INT TO BUS STATISTICS 3	MW	9:00-12:30 PM	SBS A216	B YAVAS	345
05762	QMS 322	11	PRODUCTION MGMNT 3	MW	1:00- 4:30 PM	SBS B137	M NASHIF	345
36396	QMS 423	11	INT OPTNS RESCH 3	TTH	1:00- 4:30 PM	SBS B203	F REZAYAT	345

NSM A115

SCIENCE, MATHEMATICS & TECHNOLOGY

(310) 516-3417

= evening classes

FIRST SESSION

65800	SMT 314	11	INTRO COSMOLOGY 3	MW	# 5:30- 9:20 PM	SBS G122	K LEE	345
-------	---------	----	-------------------	----	-----------------	----------	-------	-----

INTENSIVE

49136	SMT 310	61	SCIENCE & TECHNOLOGY 3 06/06 - 06/23	MTWTH	9:00-12:50 PM	SBS B215	G WIGER	345
-------	---------	----	---	-------	---------------	----------	---------	-----

SBS E306

SOCIAL & BEHAVIORAL SCIENCES

(310) 516-3429

= evening classes

FIRST SESSION

21416	SBS 318	11	CULTURAL PLURALISM 3	MW	9:00-12:50 PM	SBS E220	A HASS	345
35980	SBS 318	12	PSY OF THE HOLOCAUST CULTURAL PLURALISM 3 ETHNICITY & HEALTH	TTH	1:00- 4:50 PM	SBS A210	S ORELLANA	345
82574	SBS 318	13	CULTURAL PLURALISM 3 INT'N PERS/RACEÐNIC	MW	# 6:00- 9:50 PM	SBS E220	R HOVARO	345

SCH#	COURSE#	SECT	COURSE TITLE	UNITS	DAYS	HOURS	BLDG/RM	INSTRUCTOR	FEE
73673	SBS 318	14	CULTURAL PLURALISM	3	MWF	# 6:00- 8:30 PM	SBS 126	R CHRISTE	\$345
25605	SBS 318	15	CULTURE & URBAN COMMUNITY	3	MW	# 6:00- 10:00 PM	TBA TBA	D HEIFETZ	345
53266	SBS 318	16	CULTURAL PLURALISM	3	TTH	# 6:00- 10:00 PM	TBA TBA	STAFF	345
			OFF CAMPUS-SYLMAR						
			OFF CAMPUS-MARINA DEL REY						

SECOND SESSION

63453	SBS 318	21	CULTURAL PLURALISM	3	TTH	# 6:00- 9:50 PM	SBS G122	C UDEZE	345
-------	---------	----	--------------------	---	-----	-----------------	----------	---------	-----

SBS 318 PREREQUISITE: COMPLETION OF LOWER DIVISION SOCIAL SCIENCE REQUIREMENT

SBS B334

SOCIOLOGY

(310) 516-3431

= evening classes

FIRST SESSION

51026	SOC 305	11	METH SOC RESEARCH	4	MWTHF	2:00- 5:00 PM	TBA TBA	R CHRISTIE	460
			CO-REQ: SOC 305A						
56346	SOC 305A	11	METH SOC RESEARCH	0	MWTHF	2:00- 4:30 PM	TBA TBA	STAFF	0
			CO-REQ: SOC 305						
53443	SOC 320	11	THE FAMILY	3	MW	9:00 - 1:00 PM	SBS 219	S CARRIGAN	345
65472	SOC 340	11	SOC PSYCH:	3	TTH	# 6:00- 9:50 PM	TBA TBA	D ROBERTSON	345
05062	SOC 365	11	DEVIANT BEHAVIOR	3	TTH	1:00- 4:50 PM	SBS A144	S FELLOWS	345
57201	SOC 395	11	SPECIAL TOPICS	3	MW	# 6:00- 9:50 PM	TBA TBA	D ROBERTSON	345
			SEX ROLES IN SOCIETY						
			CO-REQ: SOC 395A						
82880	SOC 518	11	SEM MARRIAGE& FAMILY	3	MW	# 6:00- 9:40 PM	SBS B238	STAFF	345
71606	SOC 563	11	SEM DRUG & ALC USE	3	TTH	9:00-12:50 PM	SBS A144	S FELLOWS	345
38673	SOC 102	21	UNDEstand SOCIAL REL	3	TTH	9:00-1:00PM	SBS D219	S CARRIGAN	345
38673	SOC 102	21	UNDEstand SOCIAL REL	3	TTH	9:00-1:00PM	SBS D219	S CARRIGAN	345
42512	SOC 331	61	MINRTY RACIAL ETH REL	3	MTWTH	1:00- 4:50 PM	TBA	R HOVARD	345
			SOC PERSPECTIV 06/27 - 07/15						
			CR LISTED: SOC 560 61						
71374	SOC 494S	61	INDEPENDENT STUDY	3	M-SU	8:00 - 5:00 PM	TBA TBA	L MOITE	345
04690	SOC 560	61	SEM SOC RAC & ETHNIC	3	MTWTH	1:00- 4:50 PM	TBA TBA	R HOVARD	345
			CR LISTED: SOC 331 61						

SECOND SESSION

INTENSIVES

HFA E307

SPANISH

(310) 516-3315

= evening classes

FIRST SESSION

27403	SPA 305	11	ADV COMP	3	MTTH	2:00- 4:30 PM	HFA A225	F LAUERHASS	345
			SYNTAX,STYLISTCS						
78831	SPA 400	11	SCH SUBJ MATTER SPAN	3	MTWTH	4:00- 7:50 PM	FH D003	L WATTS	345
			06/06 - 06/24						
55801	SPA 305	21	ADV COMP	3	MW	4:00- 7:50 PM	SBS A204	L WATTS	345
			SYNTAX,STYLISTCS						
22610	SPA 341	61	ADV CONVERSATION	3	MTWTH	9:00-12:50 PM	HFA A33	F LAUERHASS	345
			06/27 - 07/14						
78993	SPA 230	61	SPANISH CONVERSATION	3	MTWTH	4:00- 7:50 PM	HFA A330	J CUERVO	345
			06/06 - 06/25						

INTENSIVES

UTC A101

THEATRE ARTS

(310) 516-3588

= evening classes

INTENSIVES

37741	THE 120	61	FNDMNTLS SPEECH	2	MTWTH	1:00- 5:20 PM	UT A102	P RODNEY	236
			06/6 - 06/24						
75423	THE 120	62	CO-REQ: THE 120A	2	MTWTH	1:00- 5:30 PM	UT A102	P RODNEY	236
			FNDMNTLS SPEECH						
			06/27 - 07/15						
68493	THE 120A	61	CO-REQ: THE 120A L	0	MTWTH	1:00- 5:20 PM	UT A102	P RODNEY	0
			FNDMNTLS SPEECH						
			06/06 - 06/24						
29525	THE 120A	62	CO-REQ: THE 120	0	MTWTH	1:00- 5:20 PM	UT A102	P RODNEY	0
			FNDMNTLS SPEECH						
			06/27 - 07/15						
			CO-REQ: THE 120						

CERTIFICATE PROGRAMS

Considering Re-Training?

CSUDH EDUCATION OFFERS:



Certificate Programs

Programs to help you improve your career skills

Construction Management

Occupational Health and Safety

Production and Inventory Control

Professional Supervision

Real Estate Appraisal

Technical Writing

Community College Teaching

Early Childhood Education

Alcohol and Drug Counseling

These programs can be started in Summer, Fall and Spring terms.

Call today for information: (310) 516-3741
or stop by the Office of Extended Education at 100 East Victoria,
SCC B141, **CSUDH** Carson, CA 90747-0005

AMERICAN LANGUAGE and CULTURE PROGRAM (ALCP)

(310) 516-3830 ESL COURSES

Beginning - Advanced

2 SUMMER 1994 SESSIONS:

SUMMER A: June 13 - July 8

SUMMER B: July 18 - August 12

ESL COURSES

Conversation \$315

9:00-11:50 a.m. MWF

Improve your English. This course emphasizes listening, speaking and grammar for conversational purposes.

ESL Composition \$105

1:00-1:50 p.m. MWF

Develop your writing skills. Focus on grammar, punctuation and organization.

TOEFL PREPARATION

TOEFL Grammar \$105

9:00-10:20 a.m. TTh

Prepare for the "Structure & Written Expression" section of the TOEFL.

TOEFL Listening \$105

10:30-11:50 a.m. TTh

Prepare for the "Listening Comprehension" section of the TOEFL.

TOEFL Vocabulary \$70

& Reading

1:00-1:50 p.m. TTh

Prepare for the "Vocabulary & Reading Comprehension" section of the TOEFL.

ESL INTENSIVE PROGRAM

Prepare for University Studies

20 hours of ESL instruction per week

I-20s Issued

Use of Campus Facilities

TOEFL Preparation

Professional Instructors

Small Classes

Exciting field trips

Price of 4-week session: \$650

For more information, call (310) 516-3830

American Language and Culture Program, SAC 1143

California State University Dominguez Hills

1000 E. Victoria Carson, CA USA 90747-0005

or FAX to: (310) 516-4418

To REGISTER:

Fill in the registration form below.

LATE REGISTRATION FEE OF \$25 APPLIES AFTER ORIENTATION:

June 8 Summer A Session

July 13 Summer B Session

Room numbers will be posted at the American Language and Culture Program Office, SAC 1143.
For more information, call: (310) 516-3830

AMERICAN LANGUAGE & CULTURE PROGRAM (ALCP) REGISTRATION FORM

NAME _____

ADDRESS _____

CITY STATE ZIP _____

COUNTRY OF RESIDENCE _____

COUNTRY OF CITIZENSHIP _____

TELEPHONE _____

I AM REGISTERING FOR:

COURSE _____ PRICE _____

COURSE _____ PRICE _____

COURSE _____ PRICE _____

SUMMER A SUMMER B (circle one)

TOTAL ENCLOSED _____

Make checks payable to California State University, Dominguez Hills.

Mail to:

American Language and Culture Program, SAC 1143

California State University Dominguez Hills

1000 E. Victoria, Carson, CA USA 90747-0005

or FAX to: (310) 516-4418



Community College Teaching Certificate Program

Program Requirements:

Student must be enrolled in a graduate program, possess a master's degree, or be currently employed as a faculty member in a community college.

Fall 1994 Schedule

GED 548-71 Effective College Teaching (3)

Study of research, theory, and practices associated with teaching and learning processes within the community college system. Topics include course planning and organization, student diversity, teaching and student diversity, teaching and student retention, and instructional technology.

Staff

6 Saturdays: Aug 27, Sept 10, 17, 24, Oct 8 & 15

9am-4pm

CSUDH campus room TBA

\$345

GED 594-71 College Teaching Internship (3)

Prerequisites: GED 548 and GED 549; master's degree by the time the program is completed; and minimum grade of "B" in all courses in the program.

A discipline-specific internship will be arranged for each eligible student.

Dates, Time & Location: TBA

\$345

GED 549-71 The Community College (2)

An overview of the history, mission and function of the community college. Topics include the history of higher education, the role of the community college, student characteristics, curriculum, finance, governance articulations, and the California Master Plan.

Staff

4 Saturdays: Nov 5, 12, 19, Dec 3

9am-4pm

CSUDH campus room TBA

\$230

For more
information contact
the Office of
Extended Education
(310) 516-3741

THE CENTER FOR TRAINING AND DEVELOPMENT

Custom-designed employee training programs for business, government and non-profit organizations.

On site, on Campus or at other CSUDH locations

Contract Education delivers California State University and Extended Education courses to businesses, industry, government, and non-profit organizations throughout the South Bay Area. Programs are designed to meet the unique needs of your organization and employees.

Customized training can be delivered to your offices or our campus

For more information or to schedule a free consultation, contact Scoot McKay at:

The Center for Training & Development

Extended Education

CSUDH Dominguez Hills
1000 E. Victoria Street
Carson, CA 90747-0005
or call (310) 516-3355

Program components may include:

- Basic business skills
- Management skills
- Communication skills
- Organization development
- Testing skills
- Computer training
- English fluency
- Career and technical writing

FOR TEACHERS

BEING OFFERED THIS SUMMER
ARE THE FOLLOWING COURSES

REQUIRED TO

CLEAR CREDENTIALS:

HEA 300: HEALTH IN PUBLIC
EDUCATION

GED 535 AND 535L:

INTRODUCTION TO COMPUTERS
IN EDUCATION

TED 405: MAINSTREAMING THE
CHILD WITH SPECIAL NEEDS

NEW PROGRAMS

CERTIFICATE AWARD IN OCCUPATIONAL HEALTH & SAFETY

The Certificate Program in Occupational Health & Safety is designed for individuals planning to enter the field of Health & Safety or for those already working within the field who wish to further their knowledge and advance within the field. The program will also enable a person to apply the skills and fulfill the requirements of functioning in a Health & Safety Department to administer health & safety programs in an industrial setting.



The Certificate Award in Occupational Health & Safety is endorsed by the Long Beach Chapter of the American Society of Safety Engineers.

Certificate Program in Mortgage Banking

The Certificate Program in Mortgage Banking is designed for individuals planning to enter the field of mortgage banking, or for those already working within the field who wish to further their knowledge and advance within the field. Classes meet weekday evenings from 6:30-9:45pm at the Redondo Beach Community Center or the Franklin Center in Redondo Beach.

The entire Certificate Program can be completed in three semesters (one year's time). The class will be scheduled each Fall, Spring and Summer semester. Eight courses, taught by field professionals, give the participant a strong, comprehensive background in the mortgage banking field.

The certificate in Mortgage Banking is awarded upon successful completion of eight courses.



Endorsed by
National Association of Professional Mortgage Women
California Mortgage Bankers Association
California Association of Residential Lenders

COMING '94
SUMMER THEATRE
CONSERVATORY

CALIFORNIA STATE UNIVERSITY
DOMINGUEZ HILLS
AND
THE ODYSSEY THEATRE

Participants attend seminars in acting and stage craft given by working professionals and CSUDH Theatre Department faculty while they work on productions at the Odyssey Theatre.

The Odyssey Theatre, with a 25-history in Los Angeles, is located at 2455 Sepulveda Blvd, near the 405 and Olympic Blvd. Three 99-seat theatres are housed under the same roof, so at any given time there are three plays in production, three in rehearsal and one children's show being presented. The Odyssey Theatre emphasizes culture and intellectual diversity, and a great many of the plays are originals, presented to audiences for the first time.

Be a part of it. Earn university credit, gain valuable theatre experience this summer in the CSUDH/Odyssey Theatre Collaboration. Participants need not be enrolled at CSUDH. For more information, contact:

CSUDH Extended Education, (310) 516-3741

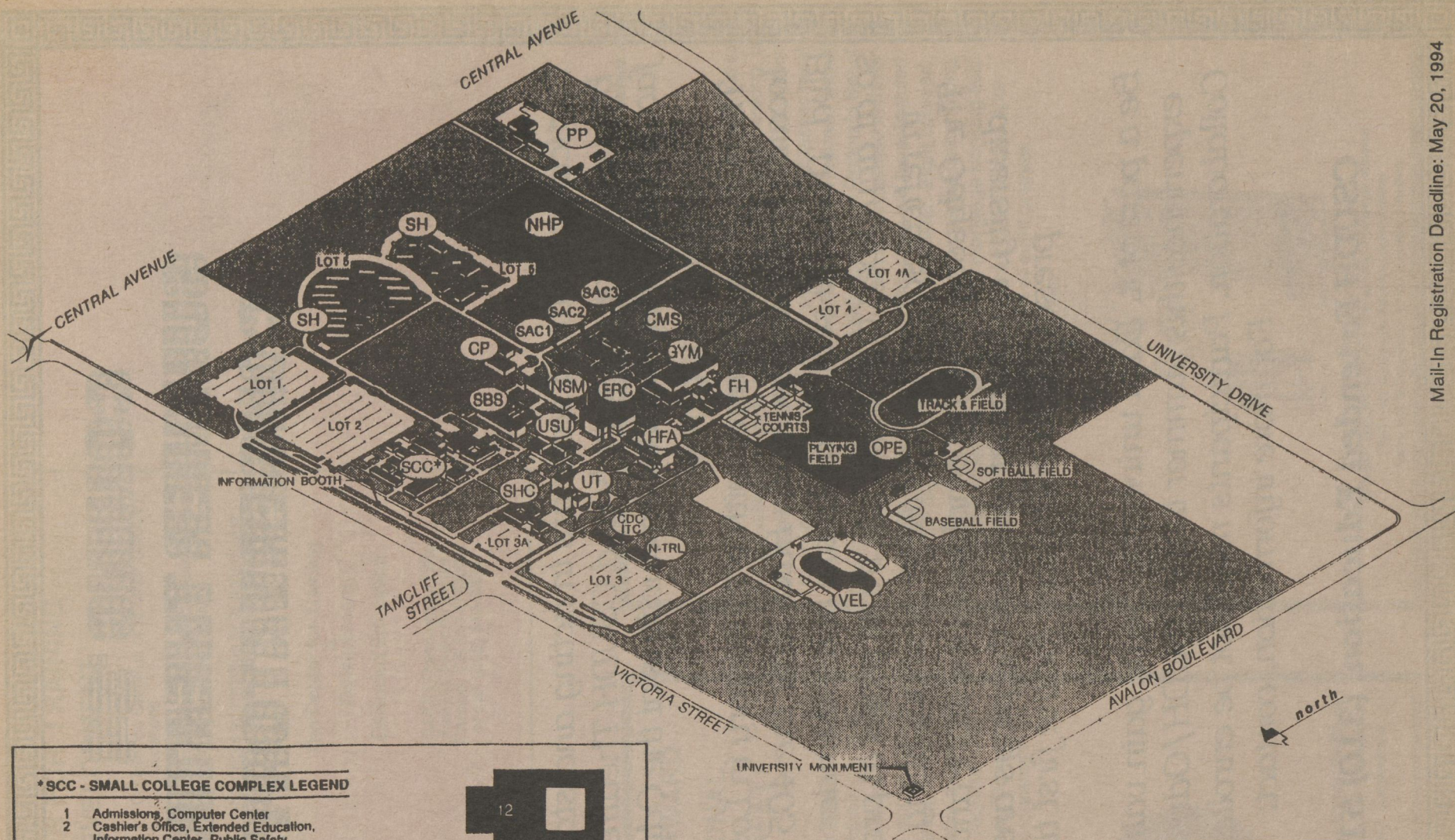

*SCC - SMALL COLLEGE COMPLEX LEGEND

- | | |
|----|---|
| 1 | Admissions, Computer Center |
| 2 | Cashier's Office, Extended Education, Information Center, Public Safety |
| 3 | Advising Center |
| 4 | Educational Opportunity Program |
| 5 | Enrollment Services, Financial Aid, International Students, Student Affirmative Action, Student Development (Career and Counseling Center), Testing |
| 6 | Classrooms Student Computer Lab |
| 7 | Classrooms |
| 8 | Classrooms |
| 9 | Classrooms |
| 10 | (Future Site 1994) Orthotics and Prosthetics Program |
| 11 | (Future Site 1994) Learning Assistance Center, Talent Search, Testing, Women's Center |
| 12 | (Future Site 1994) School of Education |
| 13 | Registrar: Records and Registration |

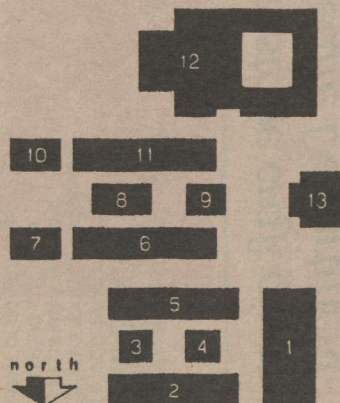

UNIVERSITY GENERAL LEGEND

- | | | | |
|-------|---|------|---|
| CDC | - CHILD DEVELOPMENT CENTER | SAC1 | - SOUTH ACADEMIC COMPLEX 1 |
| CMS | - THE CALIFORNIA ACADEMY OF MATHEMATICS AND SCIENCE LABORATORIES | SAC2 | - SOUTH ACADEMIC COMPLEX 2 |
| CP | - CENTRAL UTILITY PLANT | SAC3 | - SOUTH ACADEMIC COMPLEX 3 |
| ERC | - CAIN EDUCATIONAL RESOURCES CENTER | SBS | - The California Academy of Mathematics and Science, Faculty Offices |
| | Central Administrative Offices, Instructional Media, TV Studios, University Library | SCC | - The California Academy of Mathematics and Science |
| FH | - FIELD HOUSE (Athletics) | SH | - School of Management, Shimizu Japanese Garden |
| GYM | - GYMNASIUM | SHC | - SMALL COLLEGE COMPLEX (See legend at left) |
| HFA | - HUMANITIES AND FINE ARTS | | - STUDENT HOUSING |
| | School of Education | | - STUDENT HEALTH CENTER |
| ITC | - INFANT TODDLER CENTER | | - Disabled Students Center, Health Services and Psychological Counseling, Veterans Affairs |
| NHP | - NATURAL HISTORY PRESERVE | USU | - DONALD P. AND KATHERINE B. LOKER UNIVERSITY STUDENT UNION |
| NSM | - NATURAL SCIENCES AND MATHEMATICS | | - Bookstore, Food Service, Dining and Meeting Facilities, Recreation, Associated Students, Inc., Student Activities |
| N-TRL | - NURSING TRAINING (Temporary) | UT | - UNIVERSITY THEATRE |
| | School of Health, Statewide Nursing Program | VEL | - 7-EVEN OLYMPIC VELODROME |
| OPE | - OUTDOOR PHYSICAL EDUCATION | | |
| PP | - PHYSICAL PLANT | | |
| | Receiving Warehouse | | |

SUMMER SESSIONS 1994

REGISTRATION FORM

Social Security No: _____ Birth Date: _____
Month/Day/Year

Name: _____
Last First M.I.

Address: _____
Street City State Zip

Telephone: _____
Day Time Evening
New address? ☐ yes ☐ no male ☐ female ☐ Enrolled at CSUDH previously? ☐ yes ☐ no
Date last enrolled: _____

SCHEDULE #	DEPARTMENT	COURSE	SECTION	UNITS	COURSE FEE	INSTRUCTOR/DEPT CONSENT

Course Fee \$ _____
Student Activity Fee \$ _____ 3.00 (Mandatory)
Student Center Fee \$ _____ 10.00 (Mandatory)
ITFS Fee \$ _____
Late Fee \$ _____
TOTAL FEE SUBMITTED \$ _____

☐ Check/Money Order, Made Payable to CSUDH I AUTHORIZE THE USE OF MY: ☐ VISA ☐ MASTERCARD

ACCOUNT NUMBER _____ EXP. DATE _____

I have read and understand the rules in the Summer Sessions Bulletin regarding registration, course prerequisites, refund policy and withdrawal policy, and I authorize the use of credit card number if entered above.

Signature: _____ Date: _____
HOW TO REGISTER



MAIL TO OR STOP BY:
CSU Dominguez Hills,
EXTENDED
EDUCATION, SCC
B141, 1000 E. Victoria
Street, Carson, CA
90747.



FAX TO:
EXTENDED
EDUCATION
(310)516-3971.





YOU CAN STILL GO, BUT TIME IS OF THE ESSENCE!

Where will this summer's travel take you?

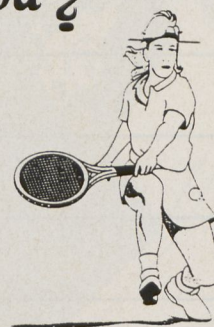

SUMMER 1994

MOROCCO-EGYPT-COSTA RICA
AUSTRALIA-INDONESIA-EASTERN EUROPE
RUSSIA& UKRAINE-BRAZIL-HAWAII
GALAPAGOS ISLANDS-KENYA-IRELAND
CHINA-ALASKA

See Travel Opportunities on Page 8 Inside.

2-415



California State University
Dominguez Hills

SUMMER SESSIONS OFFICE

1000 East Victoria Street
Carson, CA 90747

Non Profit
Organization
U.S. POSTAGE
PAID
Permit No.246
Gardena, CA